

**aalco**<sup>®</sup>

[www.aalco.co.uk](http://www.aalco.co.uk)



3	Aluminium
23	Stainless Steel
57	Copper
61	Brass
67	Bronze

Standard Stock Range



Aalco is the UK's largest independent multi-metals stockholder, with an extensive inventory of aluminium, stainless steel, copper, brass and bronze in all semi-finished forms. Aalco's inventory covers a wide range of grades/alloys, shapes and sizes - both industry standards and special or bespoke items for particular applications or individual customers.

Aalco provides customers with a cost-effective single source for all their metals requirements, together with a comprehensive processing service which includes polishing, coating, blanking and 'cut to length'

No order is too large or too small and Aalco offers a responsive and competitive service for supplying anything from single item orders to major JIT contracts, tailoring this service to the individual needs of every customer from small local businesses to major multinational corporations.

With 19 service centres nationwide, Aalco delivers on-time to every corner of the UK. Every Aalco service centre holds stocks to meet the immediate needs of customers in their local area, backed up by bulk stocks held at a central warehouse.

Whatever your requirement, in whatever quantity, your local Aalco service centre is ready and willing to satisfy your needs

For a quotation, for further information, more extensive technical information, advice on product selection or to place an order, please contact your local Aalco service centre.

If you don't see what you want within these pages, give us a call - our range is continually expanding!

June 2015 - Issue 14

#### Disclaimer

The information contained herein is based on our present knowledge and experience and is given in good faith. However no liability will be accepted by the Company in respect of any action taken by any third party in reliance thereon.

As the products used herein may be used for a wide variety of purposes and as the Company has no control over their use, the Company specifically excludes all conditions and warranties expressed or implied by statute or otherwise as to dimensions, properties and/or their fitness for any particular purpose. Any advice given by the Company to any third party is given for that party's assistance only and without any liability on the part of the Company.

Any contract between the Company and a customer will be subject to the Company's Conditions of Sale. The extent of the Company's liabilities to any customer is clearly set out in these Conditions, a copy of which is available on request.

#### Weights

All weights shown in this publication are for guidance only. They are calculated using nominal dimensions and scientifically recognised densities. Please note that in practice, the actual weight can vary significantly from theoretical weight due to variations in manufacturing tolerances and compositions.



Aluminium	
Shate.....	4
Plate.....	4
Sheet.....	5
Painted Sheet.....	7
Stucco Sheet.....	7
Treadplate.....	7
Aalcopanel Aluminium Composite Panels.....	8
Round Bar.....	9
Flat Bar.....	11
Square Bar.....	12
Equal Angle.....	13
Unequal Angle.....	14
Channel.....	15
Tee Section.....	15
Round Tube.....	16
Scaffold Tube.....	17
Box Section - Rectangular.....	18
Box Section - Square.....	18
Mouldings.....	19
Road Transport Products.....	20

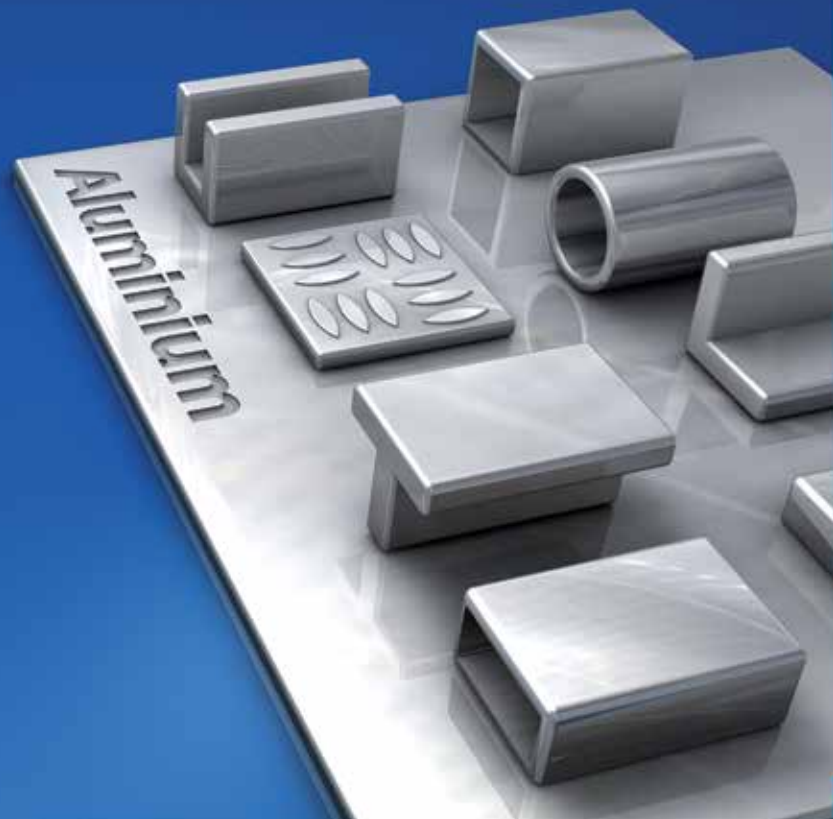

# Aluminium Shate

## Aluminium Shate Alloy 1050A H14

Size	KG/Sheet
2500mm X 1250mm X 4.0mm	34.21
2500mm X 1250mm X 5.0mm	42.77
2500mm X 1250mm X 6.0mm	51.32
2000mm X 1000mm X 6.0mm	32.85

## Aluminium Shate Alloy 5083 O/H111

Size	KG/Sheet
2500mm X 1250mm X 4.0mm	33.71
2500mm X 1250mm X 5.0mm	42.14
2500mm X 1250mm X 6.0mm	50.56
2500mm X 1250mm X 8.0mm	67.42

## Aluminium Shate Alloy 5251 H22

Size	KG/Sheet
2000mm X 1000mm X 4.0mm	21.7
2500mm X 1250mm X 4.0mm	34.0
3000mm X 1500mm X 4.0mm	48.9
2000mm X 1000mm X 5.0mm	27.2
2500mm X 1250mm X 5.0mm	42.5
3000mm X 1500mm X 5.0mm	61.1
2000mm X 1000mm X 6.0mm	32.6
2500mm X 1250mm X 6.0mm	50.9
3000mm X 1500mm X 6.0mm	73.4



## Aluminium Shate Alloy 6082 T6/T651

Size	KG/Sheet
2500mm X 1250mm X 4.0mm	34.09
2500mm X 1250mm X 5.0mm	42.61
2500mm X 1250mm X 6.0mm	51.13
2500mm X 1250mm X 8.0mm	68.18

## Aluminium Shate Alloy 5454

Size/Temper	KG/Sheet	
3048mm X 2032mm X 4.76mm (10ft X 6ft 8in)	0	80
3600mm X 2000mm X 4.76mm	H34	93
2515mm X 1829mm X 6mm (8ft 3in X 6ft)	H111	71
2595mm X 1874mm X 6mm	H24	79
2489mm X 1524mm X 6.2mm (8ft 2in X 5ft)	H22	64
2489mm X 1524mm X 6.2mm (8ft 2in X 5ft)	H34	64

# Plate



## Aluminium Plate Alloy 5083 O/H111

Size	KG/Plate
2500mm X 1250mm X 10.0mm	85
2500mm X 1250mm X 12.0mm	102
2500mm X 1250mm X 15.0mm	127
2500mm X 1250mm X 20.0mm	170
2500mm X 1250mm X 25.0mm	212

## Aluminium Plate Alloy 6082 T651

Size	KG/Plate
2500mm X 1250mm X 10.0mm	85
2500mm X 1250mm X 12.0mm	102

# Aluminium Sheet

## Aluminium Sheet Alloy 1050A H14/H24

Size	KG/Sheet
2000mm X 1000mm X 0.5mm	2.74
2500mm X 1250mm X 0.5mm	4.28
2000mm X 1000mm X 0.6mm	3.28
2500mm X 1250mm X 0.6mm	5.13
2000mm X 1000mm X 0.7mm	3.83
2500mm X 1250mm X 0.7mm	5.99
2000mm X 1000mm X 0.8mm	4.38
2500mm X 1250mm X 0.8mm	6.84
2438mm X 1219mm X 0.9mm	7.32
2000mm X 1000mm X 1.0mm	5.47
2500mm X 1250mm X 1.0mm	8.55
3000mm X 1250mm X 1.0mm	10.26
2000mm X 1000mm X 1.2mm	6.57
2438mm X 1219mm X 1.2mm	9.76
2500mm X 1250mm X 1.2mm	10.26
3000mm X 1250mm X 1.2mm	12.32
3658mm X 1250mm X 1.2mm	15.00
3000mm X 1500mm X 1.2mm	14.78
3658mm X 1500mm X 1.2mm	18.00
2000mm X 1000mm X 1.5mm	8.21
2500mm X 1000mm X 1.5mm	10.26
3000mm X 1000mm X 1.5mm	12.32
3100mm X 1000mm X 1.5mm	12.73
2500mm X 1250mm X 1.5mm	12.83
3000mm X 1250mm X 1.5mm	15.40
3250mm X 1250mm X 1.5mm	16.68
3500mm X 1250mm X 1.5mm	17.96
3658mm X 1250mm X 1.5mm	18.70

continued...

Size	KG/Sheet
3750mm X 1250mm X 1.5mm	19.25
4000mm X 1250mm X 1.5mm	20.53
2500mm X 1500mm X 1.5mm	15.40
3000mm X 1500mm X 1.5mm	18.48
3658mm X 1500mm X 1.5mm	22.50
4000mm X 1500mm X 1.5mm	24.63
2438mm x 1219mm x 1.9mm	15.46
2500mm x 1250mm x 1.9mm	16.25
3100mm x 1250mm x 1.9mm	20.15
3000mm x 1500mm x 1.9mm	23.40
4000mm x 2000mm x 1.9mm	41.20
2000mm X 1000mm X 2.0mm	10.95
2500mm X 1000mm X 2.0mm	13.69
3000mm X 1000mm X 2.0mm	16.42
4000mm X 1000mm X 2.0mm	21.90
2500mm X 1250mm X 2.0mm	17.11
3000mm X 1250mm X 2.0mm	20.53
3100mm X 1250mm X 2.0mm	21.21
3250mm X 1250mm X 2.0mm	22.24
3500mm X 1250mm X 2.0mm	23.95
3658mm X 1250mm X 2.0mm	25.00
3750mm X 1250mm X 2.0mm	25.66
4000mm X 1250mm X 2.0mm	27.37
3000mm X 1400mm X 2.0mm	22.99
4000mm X 1400mm X 2.0mm	30.66
2500mm X 1500mm X 2.0mm	20.53
3000mm X 1500mm X 2.0mm	24.63
3100mm X 1500mm X 2.0mm	25.46

continued...

Size	KG/Sheet
3250mm X 1500mm X 2.0mm	26.69
3500mm X 1500mm X 2.0mm	28.74
3658mm X 1500mm X 2.0mm	30.00
3750mm X 1500mm X 2.0mm	30.79
4000mm X 1500mm X 2.0mm	32.85
4000mm X 2000mm X 2.0mm	43.79
2438mm x 1219mm x 2.48mm	20.17
2000mm X 1000mm X 2.5mm	13.69
2500mm X 1250mm X 2.5mm	21.38
3000mm X 1500mm X 2.5mm	30.79
2438mm x 1219mm x 2.79mm	22.70
2438mm x 1219mm x 2.9mm	23.59
2500mm x 1250mm x 2.9mm	24.80
3100mm x 1250mm x 2.9mm	30.76
3000mm x 1500mm x 2.9mm	35.72
4000mm x 2000mm x 2.9mm	63.50
2000mm X 1000mm X 3.0mm	16.42
2500mm X 1000mm X 3.0mm	20.53
3000mm X 1000mm X 3.0mm	24.63
2500mm X 1250mm X 3.0mm	25.66
3000mm X 1250mm X 3.0mm	30.79
3100mm X 1250mm X 3.0mm	31.82
3250mm X 1250mm X 3.0mm	33.36
3500mm X 1250mm X 3.0mm	35.92
3658mm X 1250mm X 3.0mm	37.50
3750mm X 1250mm X 3.0mm	38.49
4000mm X 1250mm X 3.0mm	41.06
3000mm X 1400mm X 3.0mm	34.49

continued...



# Aluminium Sheet

## Aluminium Sheet Alloy 1050A H14/H24 (continued)

Size	KG/Sheet
4000mm X 1400mm X 3.0mm	45.98
2500mm X 1500mm X 3.0mm	30.79
3250mm X 1500mm X 3.0mm	40.03
3000mm X 1500mm X 3.0mm	36.95
3100mm X 1500mm X 3.0mm	38.18
3500mm X 1500mm X 3.0mm	43.11
3658mm X 1500mm X 3.0mm	44.90
3750mm X 1500mm X 3.0mm	46.19
4000mm X 2000mm X 3.0mm	65.69

## Aluminium Sheet Alloy 5251 H22

Size	KG/Sheet
2000mm X 1000mm X 1.0mm	5.43
2500mm X 1250mm X 1.0mm	8.49
2000mm X 1000mm X 1.2mm	6.52
2500mm X 1250mm X 1.2mm	10.19
2000mm X 1000mm X 1.5mm	8.15
2500mm X 1250mm X 1.5mm	12.74
3000mm X 1500mm X 1.5mm	18.34
2000mm X 1000mm X 2.0mm	10.87
2500mm X 1250mm X 2.0mm	16.98
3000mm X 1500mm X 2.0mm	24.45
2000mm X 1000mm X 2.5mm	13.58
2500mm X 1250mm X 2.5mm	21.23
2000mm X 1000mm X 3.0mm	16.30
2500mm X 1250mm X 3.0mm	25.47
3000mm X 1500mm X 3.0mm	36.68

## Aluminium Architectural Sheet Alloy 1050A H14/H24 PVC Coated one side

Size	KG/Sheet
2500mm X 1000mm X 2.0mm	13.70
2500mm X 1600mm X 2.0mm	21.90
2500mm X 1750mm X 2.0mm	23.95
3000mm X 1400mm X 2.0mm	23.0
3000mm X 1600mm X 2.0mm	26.28
3000mm X 1750mm X 2.0mm	28.74
3000mm X 2000mm X 2.0mm	32.85
3100mm X 1250mm X 2.0mm	21.20
3250mm X 1250mm X 2.0mm	22.30
3500mm X 1250mm X 2.0mm	24.00
3658mm X 1250mm X 2.0mm	25.00
3750mm X 1250mm X 2.0mm	25.70
4000mm X 1400mm X 2.0mm	30.70
4000mm X 1600mm X 2.0mm	35.03
4000mm X 1750mm X 2.0mm	38.32
2438mm X 1219mm X 2.48mm	20.10
2438mm X 1219mm X 2.9mm	23.50
2500mm X 1250mm X 2.9mm	24.70
3100mm X 1250mm X 2.9mm	30.70
3000mm X 1500mm X 2.9mm	36.90
4000mm X 2000mm X 2.9mm	63.30
2500mm X 1000mm X 3.0mm	20.60
2500mm X 1500mm X 3.0mm	30.80
2500mm X 1600mm X 3.0mm	32.90
2500mm X 1750mm X 3.0mm	35.90
3000mm X 1400mm X 3.0mm	34.50
3000mm X 1600mm X 3.0mm	39.40

continued...



## Aluminium Architectural Sheet Alloy 1050A H14/H24 PVC Coated one side (continued)

Size	KG/Sheet
3000mm X 1750mm X 3.0mm	43.10
3000mm X 2000mm X 3.0mm	49.30
3100mm X 1250mm X 3.0mm	31.90
3100mm X 1500mm X 3.0mm	38.20
3250mm X 1250mm X 3.0mm	33.40
3250mm X 1500mm X 3.0mm	39.50
3500mm X 1250mm X 3.0mm	36.00
3500mm X 1500mm X 3.0mm	43.20
3658mm X 1250mm X 3.0mm	37.40
3658mm X 1500mm X 3.0mm	44.90
3750mm X 1250mm X 3.0mm	38.50
3750mm X 1500mm X 3.0mm	46.20
4000mm X 1400mm X 3.0mm	46.00
4000mm X 1600mm X 3.0mm	52.60
4000mm X 1750mm X 3.0mm	57.50

## Aluminium Sheet Alloy 3103 H14

Size	KG/Sheet
2500mm X 1250mm X 1.5mm	12.92
2500mm X 1250mm X 2.0mm	17.23
2500mm X 1250mm X 3.0mm	25.85
3000mm X 1250mm X 3.0mm	31.02

# Aluminium Sheet



Aluminium Sheet Alloy 5083 H111

Size	KG/Sheet
2500mm X 1250mm X 1.5mm	12.64
2500mm X 1250mm X 2.0mm	16.85
2500mm X 1250mm X 3.0mm	25.28

Aluminium Sheet Alloy 6082 T6

Size	KG/Sheet
2500mm X 1250mm X 2.0mm	17.04
2500mm X 1250mm X 3.0mm	25.57

# Painted Sheet



Aluminium Painted Sheet, Alloy 3105/3003 H44 VC1 - White Painted and Vinyl Coated One Side

Size	KG/Sheet
2000mm X 1000mm X 0.5mm	2.80
2500mm X 1250mm X 0.5mm	4.30
2000mm X 1000mm X 0.6mm	3.30
2500mm X 1250mm X 0.6mm	5.20
2500mm X 1250mm X 0.9mm	7.62
2500mm X 1250mm X 1.2mm	10.20
2500mm X 1250mm X 1.5mm	12.80
2500mm X 1250mm X 2.0mm	15.50

# Stucco Sheet



Aluminium Stucco Sheet Alloy 1050A H14

Size	KG/Sheet
2000mm X 1000mm X 0.5mm	2.74
2500mm X 1250mm X 0.5mm	4.28
2000mm X 1000mm X 0.6mm	3.29
2500mm X 1250mm X 0.6mm	5.13
2000mm X 1000mm X 0.7mm	3.83
2500mm X 1250mm X 0.7mm	5.99
2000mm X 1000mm X 0.8mm	4.38
2500mm X 1250mm X 0.8mm	6.84
3000mm X 1250mm X 0.9mm	9.24
3000mm X 1500mm X 0.9mm	11.1
2500mm X 1250mm X 1.0mm	8.55
2500mm X 1250mm X 1.2mm	10.3
3000mm X 1250mm X 1.2mm	12.3
3000mm X 1500mm X 1.2mm	14.8

# Treadplate



Alco TripleGrip Aluminium Treadplate Alloy 5052 H32

Size	KG/Plate
2500 X 1250 X 1.5mm	13.9
2500 X 1250 X 2.0mm	18.1
2500 X 1250 X 3.0mm	26.6



Aluminium 5-Bar Treadplate Alloy 5754 H114

Size	KG/Plate
2438mm x 1219mm x 1.95mm	16.5
2438mm X 1219mm X 2.0mm	17.8
2500mm X 1250mm X 2.0mm	18.7
3000mm X 1500mm X 2.0mm	26.8
2438mm x 1219mm x 2.95mm	24.9
2000mm X 1000mm X 3.0mm	17.3
2438mm X 1219mm X 3.0mm	25.7
2500mm X 1250mm X 3.0mm	27.0
3000mm X 1500mm X 3.0mm	38.9
2438mm x 1219mm x 4.4mm	37.2
2000mm X 1000mm X 4.5mm	25.0
2438mm X 1219mm X 4.5mm	37.2
2500mm X 1250mm X 4.5mm	39.2
3000mm X 1500mm X 4.5mm	56.3
2438mm X 1219mm X 6.0mm	49.2
2500mm X 1250mm X 6.0mm	51.7
3000mm X 1500mm X 6.0mm	74.3

# Aluminium

## Aalcopanel Aluminium Composite Panels



All panels have a 3mm core and two Skins of Aluminium Alloy 1100  
 The Aluminium Skins are finished with Polyester Paint  
 Both painted Skins are PVC Coated with Hi-Tack 50 micron film

\*KEY  
 85% = High Gloss  
 45% = Matt

Size	Aluminium Skin Thickness (mm)	Paint Colour (RAL)	Gloss Level Front*	Gloss Level reverse*	Weight per sheet (kg)
2440 x 1220 x 3	0.3	White - 9016	85%	45%	11.40
3050 x 1500 x 3	0.3	White - 9016	85%	45%	17.40
2440 x 1220 x 3	0.3	Black - 9005	85%	45%	11.40
3050 x 1500 x 3	0.3	Black - 9005	85%	45%	17.40
2440 x 1220 x 3	0.3	White - 9016 / Silver - 9006	45%	45%	11.40
3050 x 1500 x 3	0.3	White - 9016 / Silver - 9006	45%	45%	17.40
2440 x 1220 x 3	0.3	Silver - 9006	Brushed	45%	11.40
3050 x 1500 x 3	0.3	Silver - 9006	Brushed	45%	17.40
2440 x 1220 x 3	0.3	Red - 3020	85%	45%	11.40
3050 x 1500 x 3	0.3	Red - 3020	85%	45%	17.40
2440 x 1220 x 3	0.3	Blue - 5002	85%	45%	11.40
3050 x 1500 x 3	0.3	Blue - 5002	85%	45%	17.40
2440 x 1220 x 3	0.3	Green - 6024	85%	45%	11.40
3050 x 1500 x 3	0.3	Green - 6024	85%	45%	17.40
2440 x 1220 x 3	0.3	Yellow - 1023	85%	45%	11.40
3050 x 1500 x 3	0.3	Yellow - 1023	85%	45%	17.40

### Hoarding Board

This Item has only one side painted, in Matt White, with the reverse being mill finish aluminium  
 It also has a 3mm core and two Skins of Aluminium Alloy 1100  
 Both Skins are PVC Coated with Hi-Tack 50 micron film

Size	Aluminium Skin Thickness (mm)	Paint Colour (RAL)	Gloss Level Front	Gloss Level reverse	Weight per sheet (kg)
2440 x 1220 x 3	0.21	White - 9016	Matt	Mill Finish Aluminium	10.00



# Aluminium

## Round Bar

### Aluminium Round Bar Alloy 6026 T9

Size	KG/Metre
3/8" DIA (9.525mm)	0.19
7/16" DIA (11.112mm)	0.26
1/2" DIA (12.7mm)	0.34
16mm DIA	0.54
3/4" DIA (19.05mm)	0.77
20mm DIA	0.85
7/8" DIA (22.225mm)	1.05
1" DIA (25.4mm)	1.37
1 1/8" DIA (28.58mm)	1.73
1 1/4" DIA (31.75mm)	2.14
35mm DIA	2.60
1 1/2" DIA (38.1mm)	3.08
40mm DIA	3.52
1 5/8" DIA (41.28mm)	3.61
1 3/4" DIA (44.45mm)	4.19
2" DIA (50.8mm)	5.47
2 1/4" DIA (57.15mm)	6.93
2 3/8" DIA (60.33)	7.72
2 1/2" DIA (63.5mm)	8.55
3" DIA (76.2mm)	12.31
3 1/2" DIA (88.9mm)	16.76
4" DIA (101.6mm)	21.89

### Aluminium Round Bar Alloy 2011 T3

Size	KG/Metre
7/16" DIA (11.112mm)	0.28
1/2" DIA (12.7mm)	0.36
9/16" DIA (14.287mm)	0.46
5/8" DIA (15.875mm)	0.56
3/4" DIA (19.05mm)	0.81
7/8" DIA (22.225mm)	1.10
1 1/16" DIA (17.462mm)	0.68
1 3/16" DIA (20.637mm)	0.95
1" DIA (25.4mm)	1.44
1 1/8" DIA (28.58mm)	1.82
1 1/4" DIA (31.75mm)	2.25
1 5/16" DIA (33.337mm)	2.48
1 3/8" DIA (34.93mm)	2.72
1 1/2" DIA (38.1mm)	3.24
1 5/8" DIA (41.28mm)	3.80
1 3/4" DIA (44.45mm)	4.41
1 7/8" DIA (47.65mm)	5.06
2" DIA (50.8mm)	5.76
2 1/4" DIA (57.15mm)	7.29
2 1/2" DIA (63.5mm)	8.99
2 5/8" DIA (66.67mm)	9.92
2 3/4" DIA (69.85mm)	10.88
3" DIA (76.2mm)	12.95
3 1/4" DIA (82.55mm)	15.20
3 1/2" DIA (88.9mm)	17.63
4" DIA (101.6mm)	23.02
4 1/2" DIA (114.3mm)	29.14



# Aluminium

## Round Bar

Aluminium Round Bar Alloy 6082 T6



Size	KG/Metre
¼" DIA (6.35mm)	0.09
⅕" DIA (7.937mm)	0.13
⅜" DIA (9.525mm)	0.19
½" DIA (12.7mm)	0.34
⅝" DIA (15.875mm)	0.53
¾" DIA (19.05mm)	0.77
⅞" DIA (22.225mm)	1.05
1" DIA (25.4mm)	1.37
1⅛" DIA (28.58mm)	1.73
1¼" DIA (31.75mm)	2.14
1⅜" DIA (34.93mm)	2.59
1½" DIA (38.1mm)	3.08
1⅝" DIA (41.28mm)	3.61
1¾" DIA (44.45mm)	4.19
1⅞" DIA (47.65mm)	4.81
2" DIA (50.8mm)	5.47
2⅛" DIA (53.975mm)	6.18
2¼" DIA (57.15mm)	6.93
2⅜" DIA (60.33mm)	7.72
2½" DIA (63.5mm)	8.55
2⅝" DIA (66.67mm)	9.43
2¾" DIA (69.85mm)	10.35
3" DIA (76.2mm)	12.31
3¼" DIA (82.55mm)	14.45
3½" DIA (88.9mm)	16.76

Size	KG/Metre
3¾" DIA (95.25mm)	19.24
4" DIA (101.6mm)	21.89
4¼" DIA (107.95mm)	24.71
4½" DIA (114.3mm)	27.70
4¾" DIA (120.65mm)	30.87
5" DIA (127.0mm)	34.20
5¼" DIA (133.35mm)	37.71
5½" DIA (139.7mm)	41.39
5¾" DIA (146.05mm)	45.23
6" DIA (152.4mm)	49.25
6½" DIA (165.1mm)	57.80
7" DIA (177.8mm)	67.04
7¼" DIA (184.15mm)	71.91
7½" DIA (190.5mm)	76.96
8" DIA (203.2mm)	87.56
8½" DIA (215.9mm)	98.85
9" DIA (228.6mm)	110.82
9½" DIA (241.3mm)	123.47
10" DIA (254.0mm)	136.81
12" DIA (304.8mm)	197.01
13" DIA (330.20mm)	231.21
14" DIA (355.60mm)	268.15
15" DIA (381.0mm)	307.83
16" DIA (406.40mm)	350.24

continued...

# Aluminium

## Flat Bar

Aluminium Flat Bar Alloy 6082 T6



Size	KG/Metre
3/8" X 1/4"	0.16
1/2" X 1/4"	0.22
1/2" X 3/8"	0.33
5/8" X 1/8"	0.14
5/8" X 3/16"	0.20
5/8" X 1/4"	0.27
5/8" X 3/8"	0.41
5/8" X 1/2"	0.54
3/4" X 1/8"	0.16
3/4" X 3/16"	0.24
3/4" X 1/4"	0.33
3/4" X 3/8"	0.49
3/4" X 1/2"	0.65
3/4" X 3/4"	0.82
1" X 1/8"	0.22
1" X 3/16"	0.33
1" X 1/4"	0.44
1" X 3/8"	0.54
1" X 3/4"	0.65
1" X 1/2"	0.87
1" X 5/8"	1.09
1" X 3/4"	1.31
1 1/4" X 1/8"	0.27
1 1/4" X 3/16"	0.41
1 1/4" X 1/4"	0.54
1 1/4" X 3/8"	0.82

continued...

Size	KG/Metre
1 1/4" X 1/2"	1.09
1 1/4" X 5/8"	1.36
1 1/4" X 3/4"	1.63
1 1/4" X 1"	2.18
1 1/2" X 1/8"	0.33
1 1/2" X 3/16"	0.49
1 1/2" X 1/4"	0.65
1 1/2" X 3/8"	0.98
1 1/2" X 1/2"	1.31
1 1/2" X 5/8"	1.63
1 1/2" X 3/4"	1.96
1 1/2" X 1"	2.61
1 1/2" X 1 1/4"	3.27
1 3/4" X 1/4"	0.76
1 3/4" X 3/8"	1.14
1 3/4" X 1/2"	1.52
1 3/4" X 3/4"	2.29
1 3/4" X 1"	3.05
1 3/4" X 1 1/4"	3.81
2" X 1/8"	0.44
2" X 3/16"	0.65
2" X 1/4"	0.87
2" X 3/8"	1.31
2" X 1/2"	1.74
2" X 5/8"	2.18
2" X 3/4"	2.61

continued...

Size	KG/Metre
2" X 1"	3.48
2" X 1 1/4"	4.35
2" X 1 1/2"	5.23
2 1/2" X 3/16"	0.82
2 1/2" X 1/4"	1.09
2 1/2" X 3/8"	1.63
2 1/2" X 1/2"	2.18
2 1/2" X 3/4"	3.27
2 1/2" X 1"	4.35
2 1/2" X 1 1/2"	6.53
2 1/2" X 2"	8.71
3" X 3/16"	0.98
3" X 1/4"	1.31
3" X 3/8"	1.96
3" X 1/2"	2.61
3" X 5/8"	3.27
3" X 1"	5.23
3" X 2"	10.45
3 1/2" X 1/4"	1.52
3 1/2" X 1/2"	3.05
4" X 1/8"	0.87
4" X 3/16"	1.31
4" X 1/4"	1.74
4" X 3/8"	2.61
4" X 1/2"	3.48
4" X 5/8"	4.36

continued...

# Aluminium

## Flat Bar



Aluminium Flat Bar Alloy 6082 T6 (continued)

Size	KG/Metre
4" X 3/4"	5.23
4" X 1"	6.97
4" X 1 1/4"	8.71
4" X 2"	13.94
5" X 1/2"	4.35
5" X 3/4"	2.18
6" X 1/4"	2.61
6" X 3/8"	3.92
6" X 1/2"	5.23
6" X 1"	10.45

Aluminium Flat Bar Alloy 6063A T6

Size	KG/Metre
1/2" X 1/8"	0.11
1/2" X 3/16"	0.16
7/8" X 1/8"	0.19
1" X 1/8"	0.11
1" X 1/4"	0.22
1" X 3/16"	0.33
1 1/2" X 1/8"	0.33
2" X 1/8"	0.44
3" X 1/8"	0.65
4" X 1/8"	0.87

## Square Bar



Aluminium Square Bar Alloy 6082 T6

Size	KG/Metre
1/4" SQUARE	0.11
5/16" SQUARE	0.17
3/8" SQUARE	0.25
1/2" SQUARE	0.44
5/8" SQUARE	0.68
3/4" SQUARE	0.98
7/8" SQUARE	1.34
1" SQUARE	1.74
1 1/4" SQUARE	2.72
1 1/2" SQUARE	3.92
1 3/4" SQUARE	5.34
2" SQUARE	6.97
2 1/2" SQUARE	10.90
3" SQUARE	15.80
3 1/2" SQUARE	21.40
4" SQUARE	27.90

# Aluminium

## Equal Angle

Aluminium Equal Angle Alloy 6082 T6

Size	KG/Metre
½" X ½" X ⅛"	0.19
¾" X ¾" X ⅛"	0.30
1" X 1" X ⅛"	0.41
1" X 1" X ⅜"	0.59
1" X 1" X ¼"	0.76
1¼" X 1¼" X ⅛"	0.52
1¼" X 1¼" X ⅜"	0.75
1¼" X 1¼" X ¼"	0.98
1½" X 1½" X ⅛"	0.63
1½" X 1½" X ⅜"	0.92
1½" X 1½" X ¼"	1.20
1¾" X 1¾" X ⅜"	1.08
1¾" X 1¾" X ¼"	1.42
2" X 2" X ⅛"	0.85
2" X 2" X ⅜"	1.24
2" X 2" X ¼"	1.63
2" X 2" X ⅝"	2.37
2½" X 2½" X ⅜"	1.57
2½" X 2½" X ¼"	2.07
3" X 3" X ⅛"	1.28
3" X 3" X ⅜"	1.90
3" X 3" X ¼"	2.50
3" X 3" X ⅝"	3.68
4" X 4" X ¼"	3.37
4" X 4" X ⅝"	4.98
6" X 6" X ½"	10.02

Aluminium Equal Angle Alloy 6063A T6

Size	KG/Metre
½" X ½" X ⅛"	0.10
⅝" X ⅝" X ⅛"	0.13
⅝" X ⅝" X ⅛"	0.25
¾" X ¾" X ⅛"	0.16
¾" X ¾" X ⅜"	0.30
⅞" X ⅞" X ⅛"	0.35
25mm X 25mm X 3mm	0.38
1" X 1" X ⅛"	0.21
1" X 1" X ⅜"	0.41
1¼" X 1¼" X ⅛"	0.27
1¼" X 1¼" X ⅜"	0.52
1½" X 1½" X ⅛"	0.32
1½" X 1½" X ⅜"	0.63
1¾" X 1¾" X ⅜"	0.74
50mm X 50mm X 3mm	0.79
2" X 2" X ⅛"	0.43
2" X 2" X ⅜"	0.85
2" X 2" X ⅝"	1.24
2½" X 2½" X ⅜"	1.06



# Aluminium

## Unequal Angle



Aluminium UN-Equal Angle Alloy 6063A T6

Size	KG/Metre
3/4" X 1/2" X 1/16"	0.13
3/4" X 1/2" X 1/8"	0.25
1" X 1/2" X 1/16"	0.16
1" X 1/2" X 1/8"	0.30
1" X 3/8" X 1/8"	0.33
1" X 3/4" X 1/16"	0.18
1" X 3/4" X 1/8"	0.35
1 1/4" X 1/2" X 1/8"	0.35
1 1/4" X 3/4" X 1/8"	0.41
1 1/4" X 1" X 1/8"	0.46
1 1/2" X 3/4" X 1/8"	0.46
1 1/2" X 1" X 1/8"	0.52
1 3/4" X 1" X 1/8"	0.57
2" X 1/2" X 1/8"	0.52
2" X 3/4" X 1/8"	0.57
50mm X 25mm X 3.0mm	0.58
2" X 1" X 1/8"	0.63
2" X 1 1/2" X 1/8"	0.74
2 1/2" X 1" X 1/8"	0.74
3" X 2" X 1/8"	1.06
4" X 1" X 1/8"	1.06
4" X 2" X 1/8"	1.28

Aluminium UN-Equal Angle Alloy 6082 T6

Size	KG/Metre
1 1/2" X 1" X 1/8"	0.52
2" X 1" X 1/8"	0.63
2" X 1" X 3/16"	0.92
2" X 1" X 1/4"	1.20
2" X 1 1/2" X 1/8"	0.74
2" X 1 1/2" X 3/16"	1.08
2" X 1 1/2" X 1/4"	1.41
2 1/2" X 1 1/2" X 3/16"	1.24
2 1/2" X 1 1/2" X 1/4"	1.63
3" X 1" X 1/8"	0.85
3" X 1" X 1/4"	1.64
3" X 1 1/2" X 1/8"	0.95
3" X 1 1/2" X 3/16"	1.41
3" X 1 1/2" X 1/4"	1.85
3" X 2" X 1/8"	1.06
3" X 2" X 3/16"	1.57
3" X 2" X 1/4"	2.07
4" X 2" X 1/4"	2.50
4" X 3" X 1/4"	2.94
6" X 3" X 3/8"	5.64

# Aluminium Channel



Aluminium Channel Alloy 6063/6063A T6

Size	KG/Metre
3/8" X 3/8" X 1/16" X 1/16"	0.11
1/2" X 1/2" X 1/16" X 1/16"	0.15
1/2" X 1/2" X 1/8" X 1/8"	0.27
5/8" X 5/8" X 1/16" X 1/16"	0.19
5/8" X 5/8" X 1/8" X 1/8"	0.35
3/4" X 3/4" X 1/16" X 1/16"	0.23
3/4" X 3/4" X 1/8" X 1/8"	0.44
7/8" X 7/8" X 1/8" X 1/8"	0.52
1" X 1/2" X 1/8" X 1/8"	0.38
1" X 3/4" X 1/8" X 1/8"	0.49
1" X 1" X 1/16" X 1/16"	0.31
1" X 1" X 1/8" X 1/8"	0.60
1 1/4" X 3/4" X 1/8" X 1/8"	0.55
1 1/4" X 1" X 1/8" X 1/8"	0.65
1 1/4" X 1 1/4" X 1/8" X 1/8"	0.76
1 1/2" X 3/4" X 1/8" X 1/8"	0.60
1 1/2" X 1 1/2" X 1/8" X 1/8"	0.93
1 3/4" X 1" X 1/8" X 1/8"	0.76
2" X 1/2" X 1/8" X 1/8"	0.60
2" X 3/4" X 1/8" X 1/8"	0.71
2" X 1" X 1/8" X 1/8"	0.82
2" X 1" X 3/16" X 3/16"	1.18
2" X 1 1/2" X 1/8" X 1/8"	1.04
2" X 2" X 1/8" X 1/8"	1.25
2 1/2" X 1" X 1/8" X 1/8"	0.93
4" X 2" X 1/8" X 1/8"	1.69



Aluminium Channel Alloy 6082 T6

Size	KG/Metre
1 1/4" X 1 1/4" X 1/8" X 1/8"	0.76
1 1/2" X 1 1/2" X 1/8" X 1/8"	0.49
1 1/2" X 1" X 1/8" X 1/8"	0.71
1 1/2" X 1 1/2" X 1/8" X 1/8"	0.93
1 1/2" X 1 1/2" X 3/16" X 3/16"	1.35
1 1/2" X 1 1/2" X 1/4" X 1/4"	1.74
2" X 1" X 1/8" X 1/8"	0.82
2" X 1" X 1/4" X 1/4"	1.52
2" X 1 1/2" X 1/4" X 1/4"	1.96
2" X 2" X 3/16" X 3/16"	1.84
2" X 2" X 1/4" X 1/4"	2.40
2 1/4" X 1 1/4" X 3/16" X 3/16"	1.43
2 1/2" X 1 1/4" X 3/16" X 3/16"	1.51
3" X 1" X 1/8" X 1/8"	1.04
3" X 1 1/2" X 1/8" X 1/8"	1.25
3" X 1 1/2" X 3/16" X 3/16"	1.84
3" X 1 1/2" X 1/4" X 3/16"	2.67
3" X 2" X 1/8" X 1/8"	1.47
3" X 2" X 3/16" X 3/16"	2.16
3" X 2" X 1/4" X 1/4"	2.83
3 1/2" X 1 1/2" X 1/4" X 3/16"	2.95
4" X 2" X 1/4" X 3/16"	3.65
5" X 2" X 1/4" X 3/16"	4.08
6" X 2" X 1/4" X 3/16"	4.52
6" X 3" X 1/4" X 3/16"	6.21
6" X 3" X 3/8" X 1/2"	8.49
8" X 3" X 3/8" X 1/2"	9.80
10" X 3" X 3/8" X 1/2"	11.10

# Tee Section



Aluminium Tee Alloy 6063A T6

Size	KG/Metre
3/4" X 3/4" X 1/8"	0.30
1" X 1" X 1/8"	0.41
1 1/4" X 1 1/4" X 1/8"	0.52
1 1/2" X 1 1/2" X 1/8"	0.63
2" X 1" X 1/8"	0.63
2" X 2" X 1/8"	0.85

Aluminium Tee Alloy 6082 T6

Size	KG/Metre
1 1/2" X 1 1/2" X 3/16"	0.92
1 1/2" X 1 1/2" X 1/4"	1.20
2" X 2" X 3/16"	1.25
2" X 2" X 1/4"	1.63
3" X 3" X 1/4"	2.51

# Aluminium

## Round Tube



Aluminium Tube Alloy 6082 T6

Size	KG/Metre
½" O/D X 10SWG	0.26
⅝" O/D X 10SWG	0.35
¾" O/D X 10SWG	0.44
⅞" O/D X 10SWG	0.52
1" O/D X 16SWG	0.33
1" O/D X 10SWG	0.61
1" O/D X ⅜"	0.83
1" O/D X ¼"	1.03
1⅞" O/D X 10SWG	0.70
1¼" O/D X 16SWG	0.40
1¼" O/D X ⅜"	1.10
1¼" O/D X 10SWG	0.80
1⅜" O/D X 10SWG	0.87
1½" O/D X 10SWG	0.96
1½" O/D X ⅜"	1.35
1½" O/D X ¼"	1.71
1⅝" O/D X 10SWG	1.00
1⅝" O/D X ⅜"	1.50
1¾" O/D X 16SWG	0.59
1¾" O/D X 10SWG	1.14
1⅞" O/D X 10SWG	1.22
2" O/D X 16SWG	0.70
2" O/D X 10SWG	1.30
2" O/D X ⅜"	1.90
2" O/D X ¼"	2.40
2¼" O/D X 16SWG	0.77

continued...

Aluminium Tube Alloy 6082 T6 (continued)

Size	KG/Metre
2¼" O/D X 10SWG	1.49
2½" O/D X 16SWG	0.90
2½" O/D X 10SWG	1.60
2½" O/D X ⅜"	2.40
2½" O/D X ¼"	3.10
2½" O/D X ⅝"	4.40
3½" O/D X ¼"	4.45
2¾" O/D X 10SWG	1.80
3" O/D X 16SWG	1.00
3" O/D X 10SWG	2.00
3" O/D X ⅜"	2.90
3" O/D X ¼"	3.80
3½" O/D X 16SWG	1.21
3½" O/D X 10SWG	2.36
4" O/D X 10SWG	2.71
4" O/D X ¼"	5.13
4½" O/D X 10SWG	3.00
4½" O/D X ¼"	5.80
5" O/D X 10SWG	3.30
5" O/D X ¼"	6.50
6" O/D X 10SWG	4.03
6" O/D X ¼"	7.90
6½" O/D X ¼"	8.55

Aluminium Tube Alloy 6063 T6

Size	KG/Metre
⅜" O/D X 16SWG	0.11
½" O/D X 18SWG	0.12
½" O/D X 16SWG	0.15
⅝" O/D X 18SWG	0.15
⅝" O/D X 16SWG	0.20
¾" O/D X 18SWG	0.18
¾" O/D X 16SWG	0.24
¾" O/D X 10SWG	0.44
⅞" O/D X 18SWG	0.22
⅞" O/D X 16SWG	0.28
⅞" O/D X 10SWG	0.52
1" O/D X 18SWG	0.25
1" O/D X 10SWG	0.61
1⅞" O/D X 16SWG	0.37
1¼" O/D X 18SWG	0.32
1¼" O/D X 16SWG	0.40
1¼" O/D X 10SWG	0.80
1⅜" O/D X 16SWG	0.46
1½" O/D X 18SWG	0.38
1½" O/D X 16SWG	0.50
1½" O/D X 10SWG	0.96
1⅝" O/D X 16SWG	0.50
2" O/D X 16SWG	0.70
2" O/D X 10SWG	1.30
2¼" O/D X 10SWG	1.49
3" O/D X 10SWG	2.00
4" O/D X 16SWG	1.38
4" O/D X 16SWG	1.38



# Aluminium

## Round Tube - for rainwater handling

Aluminium Tube Alloy 6082 T6 (BS1474)

Size	KG/Metre
1¼" OD X 10SWG	1.14
2" OD X ¼"	2.39
2" OD X ⅜"	1.86
2" OD X 1.5mm	0.63
3" OD X 1.5mm	0.95
3 ½" OD X ¼"	4.45
4" OD X 16SWG	1.38
4" OD X 1.5mm	1.27
100mm OD X 2mm	1.66
150mm OD X 2mm	2.51
152mm OD X 2.5mm	3.17
2" OD X 3.0mm	1.22
3" OD X 3.0mm	1.87
3½" OD X ¼"	4.45
4" OD X 3.0mm	2.51

## Scaffold Tube

Scaffold tube is drift tested to BS 1139

Size	KG/Metre
1 <sup>29</sup> / <sub>32</sub> o/d x 7swg (0.176"/4.47mm)	1.53



# Aluminium

## Box Section - Rectangular



Aluminium Rectangular Tube Alloy 6063 T6

Size	KG/Metre
1½" X ¾" X ⅙"	0.46
1½" X 1" X 16SWG	0.53
1½" X 1" X 10SWG	1.00
50mm X 25mm X 3.0mm	1.18
2" X 1" X 10SWG	1.22
2" X 1½" X 10SWG	1.45
3" X 1" X 10SWG	1.67
3" X 1½" X 10SWG	1.89
3" X 2" X 10SWG	2.11
4" X 1" X 10SWG	2.11
4" X 1¾" X 10SWG	2.45
4" X 2" X 10SWG	2.56
6" X 2" X 10SWG	3.45
6" X 3" X ⅜"	10.80

## Box Section - Square



Aluminium Square Tube Alloy 6082 T6

Size	KG/Metre
½" SQ X 16SWG	0.20
¾" SQ X 16SWG	0.31
1" SQ X 16SWG	0.42
1" SQ X 10SWG	0.78
1¼" SQ X 16SWG	0.53
1¼" SQ X 10SWG	1.00
1½" SQ X 16SWG	0.64
1½" SQ X 10SWG	1.22
1¾" SQ X 10SWG	1.45
2" SQ X 16SWG	0.87
2" SQ X 10SWG	1.67
2½" SQ X 10SWG	2.12
3" SQ X 10SWG	2.56

Aluminium Square Tube Alloy 6082 T6

Size	KG/Metre
50mm X 50mm X 1.5mm	0.79
50mm X 50mm X 3.0mm	1.52
75mm X 75mm X 1.5mm	1.19
100mm X 100mm X 1.5mm	1.60
100mm X 100mm X 2.0mm	2.12
150mm X 150mm X 3.0mm	4.76



Aluminium Square Tube Alloy 6063 T6

Size	KG/Metre
1" SQ X 10SWG	0.78
1¼" SQ X 16SWG	0.53
1½" SQ X 10SWG	1.22
2" SQ X 10SWG	1.67
2" SQ X ⅙"	3.05
4" SQ X 10SWG	3.45
4" SQ X ⅙"	6.53

# Aluminium

## Mouldings



These are a selection of the many shapes available and may not be shown at actual size

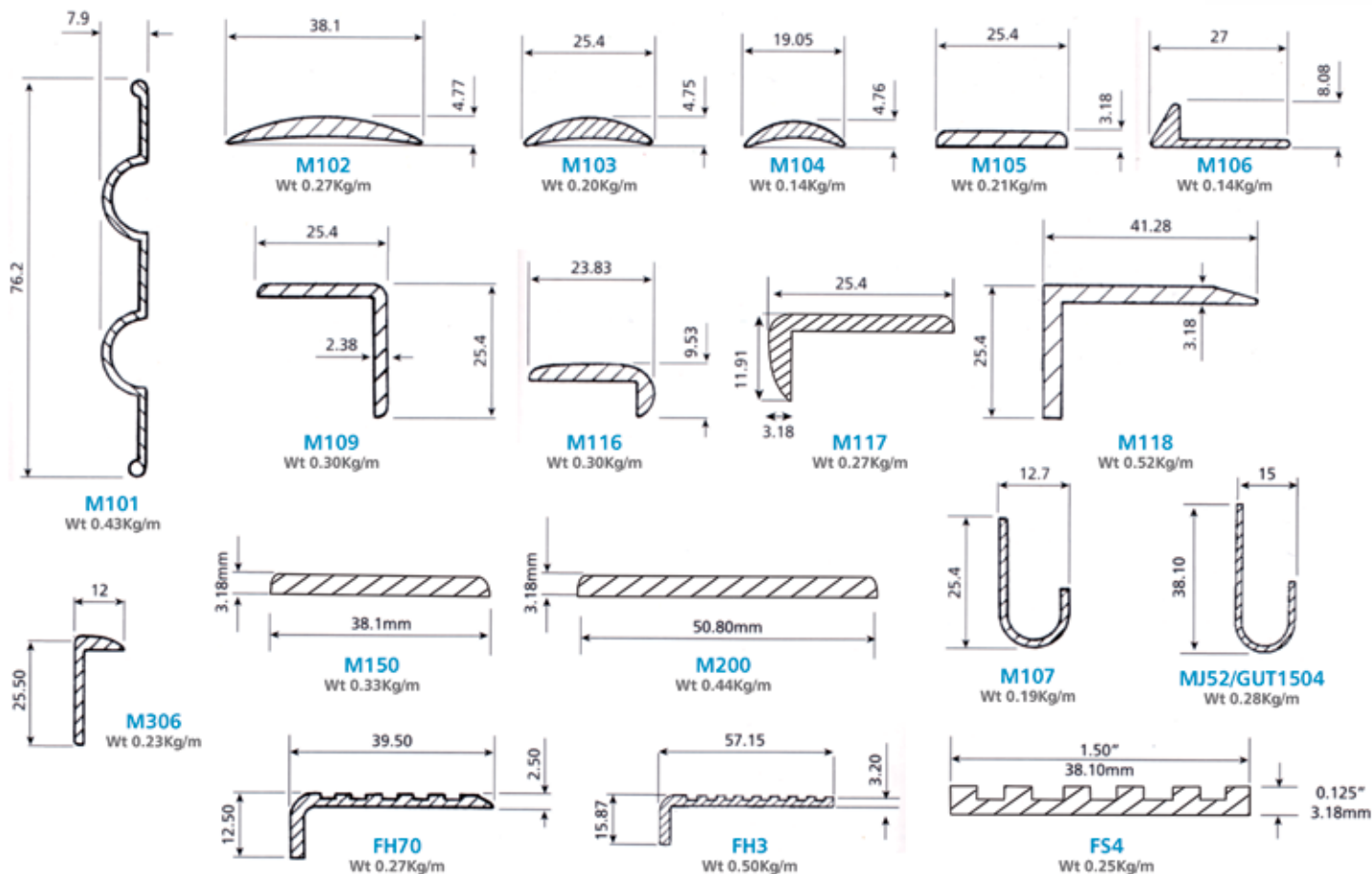

# Aluminium

## Road Transport Products

Aalco stocks an extensive range of products for the RT sector, covered in a separate catalogue available from your local Service Centre

**Rolled Products** - sheet & patterned sheet, plate & treadplate, shate



**Standard Extrusions** - angle, channel, tee, tube & box section, flat/square/round bar



**Special Sections** - Bearers/Runners, Floor Planks, Side Raves & Guards, Corner Pillars, Cant Rails, Top Hats, Zeds, Mouldings, Kick Strips

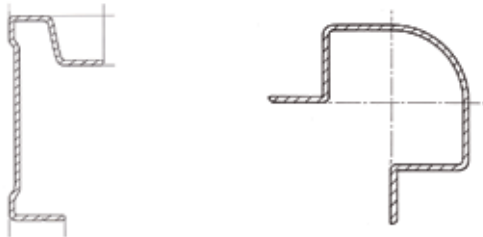

**Dropside Sections & Systems**

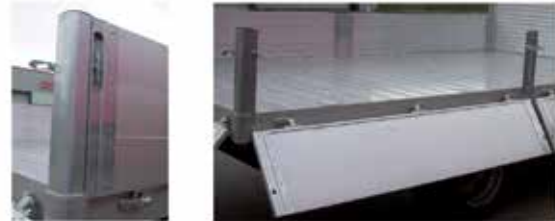

**Lightweight Dropside System** - Complete aluminium system including heavy duty pillars and extruded plank flooring. Full information is provided in a separate leaflet available free on request.



# Aluminium

## Road Transport Products

Aalco stocks an extensive range of products for the RT sector, covered in a separate catalogue available from your local Service Centre



### Aluminium Flooring - Treadplate & Floor Plank Extrusions

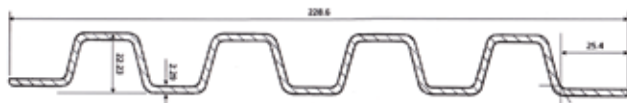
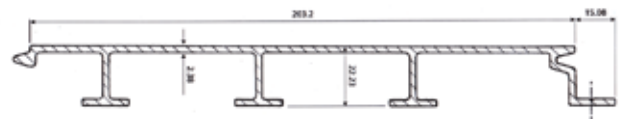

### GRP - Panels, Corner Pillars & Cant Rails

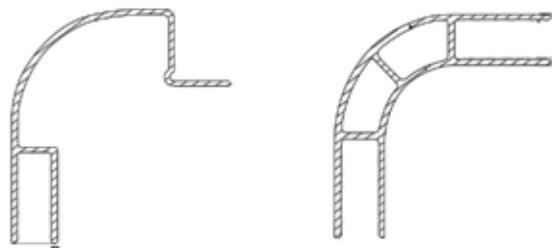

### Side Guard - Aluminium



# Aluminium

## Road Transport Products

Aalco stocks an extensive range of products for the RT sector, covered in a separate catalogue available from your local Service Centre

**Cappings - ABS & Aluminium/ABS**

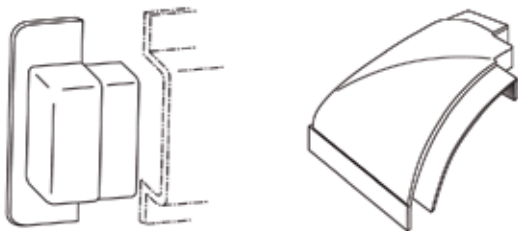

**Slip-resistant flooring - Phenolic mesh-faced Birch wood plywood**

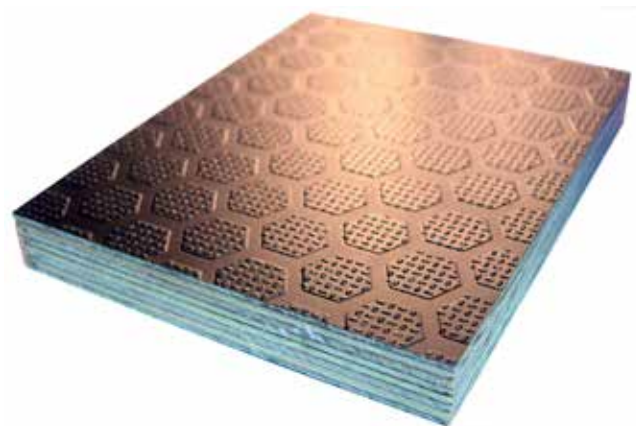

# Aalco Stainless Steel

Contents	
Plate .....	24
Sheet .....	25
Equal Angle .....	27
Round Bar .....	28
Hexagon Bar .....	30
Square Bar .....	30
Flat Bar - Hot Rolled .....	31
Flat Bar - Rolled Edge .....	32
Structural & Decorative Tube - Round .....	33
Structural & Decorative Tube - Square .....	34
Structural & Decorative Tube - Rectangular .....	36
Pipe .....	38
Butt Weld Fittings .....	40
High Pressure Fittings - Threaded .....	44
High Pressure Fittings - Socket Weld .....	45
Flanges .....	46
Metric Tube and Fittings .....	48
Seamless Tube .....	49
BSP Fittings .....	51
Hygenic Tube and Fittings .....	52
Handrail Tube and Fittings .....	53
Slotted Tube system and fittings .....	55
Accessories - Adhesive & Cleaners .....	56



# Stainless Steel

## Plate



### Stainless Steel Hot Rolled Plate Grade 1.4003

Size	KG/Plate
2000mm X 1000mm X 3.0mm	48
2500mm X 1250mm X 3.0mm	75
3000mm X 1500mm X 3.0mm	108
2000mm X 1000mm X 4.0mm	64
2500mm X 1250mm X 4.0mm	100
3000mm X 1500mm X 4.0mm	144
2000mm X 1000mm X 5.0mm	80
2500mm X 1250mm X 5.0mm	125
2500mm X 1250mm X 6.0mm	150
3000mm X 1500mm X 6.0mm	216
2500mm X 1250mm X 8.0mm	200
3000mm X 1500mm X 8.0mm	288
2500mm X 1250mm X 10.0mm	250
3000mm X 1500mm X 10.0mm	360
2500mm X 1250mm X 12.0mm	300
3000mm X 1500mm X 12.0mm	432

### Stainless Steel Cold Rolled Plate Grades 1.4307 (304L) & 1.4404 (316L) PVC Coated 1 Side

Size	KG/Plate
4000mm X 2000mm X 4.0mm	256
4000mm X 2000mm X 5.0mm	320
4000mm X 2000mm X 6.0mm	384

### Stainless Steel Hot Rolled Plate Grades 1.4307 (304L) & 1.4404 (316L)

Size	KG/Plate
2000mm X 1000mm X 3.0mm	48
2500mm X 1250mm X 3.0mm	75
3000mm X 1500mm X 3.0mm	108
2000mm X 1000mm X 4.0mm	64
2500mm X 1250mm X 4.0mm	100
3000mm X 1500mm X 4.0mm	144
2000mm X 1000mm X 5.0mm	80
2500mm X 1250mm X 5.0mm	125
3000mm X 1500mm X 5.0mm	180
4000mm X 2000mm X 5.0mm	320
2000mm X 1000mm X 6.0mm	96
2500mm X 1250mm X 6.0mm	150
3000mm X 1500mm X 6.0mm	216
4000mm X 2000mm X 6.0mm	384
6000mm X 2000mm X 6.0mm	576
2000mm X 1000mm X 8.0mm	128
2500mm X 1250mm X 8.0mm	200
3000mm X 1500mm X 8.0mm	288
4000mm X 2000mm X 8.0mm	512
2000mm X 1000mm X 10.0mm	160
2500mm X 1250mm X 10.0mm	250
3000mm X 1500mm X 10.0mm	360
4000mm X 2000mm X 10.0mm	640
6000mm X 2000mm X 10.0mm	960
2500mm X 1250mm X 12.0mm	300
3000mm X 1500mm X 12.0mm	432

Size	KG/Plate
4000mm X 2000mm X 12.0mm	768
2500mm X 1250mm X 15.0mm	375
3000mm X 1500mm X 15.0mm	557
2500mm X 1250mm X 20.0mm	500
3000mm X 1500mm X 20.0mm	720

### Stainless Steel Cold Rolled Plate Grades 1.4307 (304L) & 1.4404 (316L)

Size	KG/Plate
2000mm X 1000mm X 4.0mm	64
2500mm X 1250mm X 4.0mm	100
3000mm X 1500mm X 4.0mm	144
2000mm X 1000mm X 5.0mm	80
2500mm X 1250mm X 5.0mm	125
3000mm X 1500mm X 5.0mm	180
2000mm X 1000mm X 6.0mm	96
2500mm X 1250mm X 6.0mm	150
3000mm X 1500mm X 6.0mm	216

### Stainless Steel Treadplate BSEN 10088: Part 3 / ASTM A793 / DIN 59220 (T) Pattern 1 Grade AISI 304

Size	KG/Plate
3000mm X 1000mm X 3.0mm	78
3000mm X 1250mm X 3.0mm	98
3000mm X 1250mm X 4.5mm	143
3000mm X 1250mm X 6.0mm	180

continued...



# Stainless Steel

## Sheet



**Stainless Steel Sheet Grade 1.4003 - Cold Rolled**  
except where shown

Size	KG/Sheet
2500mm X 1250mm X 1.0mm	25.0
2000mm X 1000mm X 1.2mm	19.2
2500mm X 1250mm X 1.2mm	30.0
2000mm X 1000mm X 1.5mm	24.0
2500mm X 1250mm X 1.5mm	37.5
3000mm X 1500mm X 1.5mm	54.0
2000mm X 1000mm X 2.0mm	32.0
2500mm X 1250mm X 2.0mm	50.0
3000mm X 1500mm X 2.0mm	72.0
2500mm X 1250mm X 2.5mm	62.5
2000mm X 1000mm X 3.0mm (HR)	48.0
2500mm X 1250mm X 3.0mm (HR)	75.0
3000mm X 1500mm X 3.0mm (HR)	108.0

**Stainless Steel Sheet Grade 1.4016 (430) - Polished**  
240 Grit and PVC Coated 1 Side

Size	KG/Sheet
2500mm X 1250mm X 0.7mm	17.9
2000mm X 1000mm X 0.9mm	14.7
2500mm X 1250mm X 0.9mm	23.0
2000mm X 1000mm X 1.2mm	19.6
2500mm X 1250mm X 1.2mm	30.7
2000mm X 1000mm X 1.5mm	24.6
2500mm X 1250mm X 1.5mm	38.4

**Stainless Steel Sheet Grade 1.4016 (430) - Bright**  
Annealed

Size	KG/Sheet
2000mm X 1000mm X 0.5mm	8.2
2500mm X 1250mm X 0.5mm	12.8
2000mm X 1000mm X 0.7mm	11.5
2500mm X 1250mm X 0.7mm	17.9
2000mm X 1000mm X 0.9mm	14.7
2500mm X 1250mm X 0.9mm	23.0
2000mm X 1000mm X 1.0mm	16.4
2500mm X 1250mm X 1.0mm	25.6
2000mm X 1000mm X 1.2mm	19.6
2500mm X 1250mm X 1.2mm	30.7
2000mm X 1000mm X 1.5mm	24.6
2500mm X 1250mm X 1.5mm	38.4
2000mm X 1000mm X 2.0mm	32.7
2500mm X 1250mm X 2.0mm	51.2

**Stainless Steel Sheet Grade 1.4404 (316L) - Polished**  
240 Grit and PVC Coated 1 Side

Size	KG/Sheet
2500mm X 1250mm X 0.9mm	23.0
2500mm X 1250mm X 1.2mm	31.2
2500mm X 1250mm X 1.5mm	38.4
3000mm X 1500mm X 1.5mm	55.3
2500mm X 1250mm X 2.0mm	51.2
2500mm X 1250mm X 3.0mm	77.5

**Stainless Steel Sheet Grade 1.4301 (304) - Polished**  
240 Grit and PVC Coated 1 Side

Size	KG/Sheet
2000mm X 1000mm X 0.7mm	11.5
2500mm X 1250mm X 0.7mm	17.9
2000mm X 1000mm X 0.9mm	14.7
2500mm X 1250mm X 0.9mm	23.0
3000mm X 1500mm X 0.9mm	33.2
2000mm X 1000mm X 1.0mm	16.4
2500mm X 1250mm X 1.0mm	25.6
2000mm X 1000mm X 1.2mm	19.6
2500mm X 1250mm X 1.2mm	30.7
3000mm X 1500mm X 1.2mm	44.2
2000mm X 1000mm X 1.5mm	24.6
2500mm X 1250mm X 1.5mm	38.4
3000mm X 1500mm X 1.5mm	55.3
2000mm X 1000mm X 2.0mm	32.7
2500mm X 1250mm X 2.0mm	51.2
3000mm X 1500mm X 2.0mm	73.7
2000mm X 1000mm X 2.5mm	40.9
2500mm X 1250mm X 2.5mm	63.9
3000mm X 1500mm X 2.5mm	92.1
2000mm X 1000mm X 3.0mm	49.6
2500mm X 1250mm X 3.0mm	77.5
3000mm X 1500mm X 3.0mm	111.6

# Stainless Steel

## Sheet

Stainless Steel Sheet Grade 1.4301 (304) - 2B

Size	KG/Sheet
2000mm X 1000mm X 0.5mm	8.2
2500mm X 1250mm X 0.5mm	12.8
2000mm X 1000mm X 0.7mm	11.5
2500mm X 1250mm X 0.7mm	17.9
2500mm X 1250mm X 0.8mm	20.5
2000mm X 1000mm X 0.9mm	14.7
2500mm X 1250mm X 0.9mm	23.0
3000mm X 1500mm X 0.9mm	33.2
2000mm X 1000mm X 1.0mm	16.4
2500mm X 1250mm X 1.0mm	25.6
2000mm X 1000mm X 1.2mm	19.6
2500mm X 1250mm X 1.2mm	30.7
3000mm X 1500mm X 1.2mm	44.2
2000mm X 1000mm X 1.5mm	24.6
2500mm X 1250mm X 1.5mm	38.4
3000mm X 1500mm X 1.5mm	55.3
2000mm X 1000mm X 2.0mm	32.7
2500mm X 1250mm X 2.0mm	51.2
3000mm X 1500mm X 2.0mm	73.7
4000mm X 2000mm X 2.0mm	128.0
2000mm X 1000mm X 2.5mm	40.9
2500mm X 1250mm X 2.5mm	63.9
3000mm X 1500mm X 2.5mm	92.1
2000mm X 1000mm X 3.0mm	49.6
2500mm X 1250mm X 3.0mm	77.5
3000mm X 1500mm X 3.0mm	111.6
4000mm X 2000mm X 3.0mm	192.0

Stainless Steel Sheet Grade 1.4404 (316L) - 2B

Size	KG/Sheet
2000mm X 1000mm X 0.7mm	11.5
2500mm X 1250mm X 0.7mm	17.9
2000mm X 1000mm X 0.9mm	14.7
2500mm X 1250mm X 0.9mm	23.0
2000mm X 1000mm X 1.2mm	19.6
2500mm X 1250mm X 1.2mm	30.7
3000mm X 1500mm X 1.2mm	44.2
2000mm X 1000mm X 1.5mm	24.6
2500mm X 1250mm X 1.5mm	38.4
3000mm X 1500mm X 1.5mm	55.3
2000mm X 1000mm X 2.0mm	32.7
2500mm X 1250mm X 2.0mm	51.2
3000mm X 1500mm X 2.0mm	73.7
4000mm X 2000mm X 2.0mm	128.0
2000mm X 1000mm X 2.5mm	40.9
2500mm X 1250mm X 2.5mm	63.9
3000mm X 1500mm X 2.5mm	92.1
2000mm X 1000mm X 3.0mm	49.6
2500mm X 1250mm X 3.0mm	77.5
3000mm X 1500mm X 3.0mm	111.6
4000mm X 2000mm X 3.0mm	192.0



Stainless Steel Sheet Grade 1.4301 (304) - OPTISHEEN™ Polished and PVC Coated 1 Side

Size	KG/Sheet
2000mm X 1000mm X 0.9mm	14.7
2500mm X 1250mm X 0.9mm	23.0
2000mm X 1000mm X 1.2mm	19.6
2500mm X 1250mm X 1.2mm	30.7
2000mm X 1000mm X 1.5mm	24.6
2500mm X 1250mm X 1.5mm	38.4
3000mm X 1500mm X 1.5mm	55.3
2500mm X 1250mm X 2.0mm	51.2

Stainless Steel Sheet Grade 1.4301 (304) - 240 Grit Silicon Polished and PVC Coated 1 Side

Size	KG/Sheet
2000mm X 1000mm X 0.9mm	14.7
2500mm X 1250mm X 0.9mm	23.0
2000mm X 1000mm X 1.2mm	19.6
2500mm X 1250mm X 1.2mm	30.7
2000mm X 1000mm X 1.5mm	24.6
2500mm X 1250mm X 1.5mm	38.4
2000mm X 1000mm X 2.0mm	32.7
2500mm X 1250mm X 2.0mm	51.2

# Stainless Steel

## Sheet



Stainless Steel Sheet  
Grade 1.4301 (304) - Bright Annealed

Size	KG/Sheet
2500mm X 1250mm X 0.5mm	12.8
2000mm X 1000mm X 0.5mm	8.2
2000mm X 1000mm X 0.6mm	9.8
2500mm X 1250mm X 0.6mm	15.3
2000mm X 1000mm X 0.7mm	11.5
2500mm X 1250mm X 0.7mm	17.9
2500mm X 1250mm X 0.8mm	20.5
2000mm X 1000mm X 0.9mm	14.7
2500mm X 1250mm X 0.9mm	23.0
2000mm X 1000mm X 1.0mm	16.4
2500mm X 1250mm X 1.0mm	25.6
2000mm X 1000mm X 1.2mm	19.6
2500mm X 1250mm X 1.2mm	30.7
2000mm X 1000mm X 1.5mm	24.6
2500mm X 1250mm X 1.5mm	38.4
2000mm X 1000mm X 2.0mm	32.7
2500mm X 1250mm X 2.0mm	51.2

## Circle Polished Sheet



Circle Polished Stainless Steel Sheet  
Grade 1.4301 (304) - 50mm Circles

Size	KG/Sheet
2500mm x 1250mm x 0.9mm	23.0
2500mm x 1250mm x 1.2mm	30.7
2500mm x 1250mm x 1.5mm	38.4
2500mm x 1250mm x 2.0mm	51.2

Circle Polished Stainless Steel Sheet  
Grade 1.4016 (430) - 50mm Circles

Size	KG/Sheet
2500mm x 1250mm x 0.9mm	23.0

## Equal Angle



Stainless Steel Angle Grades 1.4307 (304L) & 1.4404 (316L)

Size	KG/Metre
20.0mm X 20.0mm X 3.0mm	0.95
25.0mm X 25.0mm X 3.0mm	1.20
25.0mm X 25.0mm X 5.0mm	1.92
25.0mm X 25.0mm X 6.0mm	2.25
30.0mm X 30.0mm X 3.0mm	1.46
30.0mm X 30.0mm X 5.0mm	2.35
30.0mm X 30.0mm X 6.0mm	2.76
40.0mm X 40.0mm X 3.0mm	1.97
40.0mm X 40.0mm X 5.0mm	3.20
40.0mm X 40.0mm X 6.0mm	3.79
50.0mm X 50.0mm X 3.0mm	2.48
50.0mm X 50.0mm X 5.0mm	4.05
50.0mm X 50.0mm X 6.0mm	4.81
50.0mm X 50.0mm X 10.0mm	7.68
60.0mm X 60.0mm X 5.0mm	4.91
60.0mm X 60.0mm X 6.0mm	5.84
60.0mm X 60.0mm X 10.0mm	9.39
70.0mm X 70.0mm X 6.0mm	6.86
70.0mm X 70.0mm X 10.0mm	11.10
75.0mm X 75.0mm X 6.0mm	7.37
75.0mm X 75.0mm X 10.0mm	11.95
80.0mm X 80.0mm X 6.0mm	7.88
80.0mm X 80.0mm X 10.0mm	12.80
100.0mm X 100.0mm X 6.0mm	9.93
100.0mm X 100.0mm X 10.0mm	16.21

# Stainless Steel

## Round Bar

Stainless Steel Round Bar Grade 1.4305 (303)



Size	KG/Metre
3.0mm DIA	0.06
½" DIA (3.175mm)	0.06
4.0mm DIA	0.10
¾" DIA (4.762mm)	0.14
5.0mm DIA	0.16
6.0mm DIA	0.22
¼" DIA (6.35mm)	0.25
7.0mm DIA	0.30
⅝" DIA (7.937mm)	0.39
8.0mm DIA	0.40
⅜" DIA (9.525mm)	0.56
10.0mm DIA	0.62
⅞" DIA (11.112mm)	0.77
12.0mm DIA	0.89
½" DIA (12.7mm)	1.00
14.0mm DIA	1.22
⅝" DIA (14.287mm)	1.27
15.0mm DIA	1.40
⅝" DIA (15.875mm)	1.56
16.0mm DIA	1.59
⅞" DIA (17.462mm)	1.89
18.0mm DIA	2.01
¾" DIA (19.05mm)	2.25
20.0mm DIA	2.48
22.0mm DIA	3.00
⅞" DIA (22.225mm)	3.07

continued...

Size	KG/Metre
24.0mm DIA	3.57
25.0mm DIA	3.88
1" DIA (25.4mm)	4.00
1⅛" DIA (28.575mm)	5.07
30.0mm DIA	5.58
1¼" DIA (31.75mm)	6.25
1⅜" DIA (34.925mm)	7.57
35.0mm DIA	7.60
1½" DIA (38.1mm)	9.01
40.0mm DIA	9.93
1⅝" DIA (41.275mm)	10.6
1¾" DIA (44.45mm)	12.3
45.0mm DIA	12.6
1⅞" DIA (47.625mm)	14.1
50.0mm DIA	15.5
2" DIA (50.8mm)	16.0
2⅞" DIA (53.975mm)	18.1
2¼" DIA (57.15mm)	20.3
60.0mm DIA	22.3
2⅜" DIA (60.325mm)	22.6
2½" DIA (63.5mm)	25.0
2⅝" DIA (66.67mm)	27.6
2¾" DIA (69.85mm)	30.3
3" DIA (76.2mm)	36.0
3¼" DIA (82.55mm)	42.9
3½" DIA (88.9mm)	49.8

continued...

Size	KG/Metre
3¾" DIA (95.25mm)	57.1
4" DIA (101.6mm)	65.0
4¼" DIA (107.95mm)	73.4
4½" DIA (114.3mm)	82.3
5" DIA (127.0mm)	102
5¾" DIA (146.05mm)	134
6" DIA (152.4mm)	146
7" DIA (177.8mm)	199

# Stainless Steel

## Round Bar

Stainless Steel Round Bar Grades 1.4307 (304L) & 1.4404 (316L)



Size	KG/Metre
3.0mm DIA	0.06
½" DIA (3.175mm)	0.06
4.0mm DIA	0.10
¾" DIA (4.762mm)	0.14
5.0mm DIA	0.16
6.0mm DIA	0.22
¼" DIA (6.35mm)	0.25
⅝" DIA (7.937mm)	0.39
8.0mm DIA	0.40
⅜" DIA (9.525mm)	0.56
10.0mm DIA	0.62
⅞" DIA (11.112mm)	0.77
12.0mm DIA	0.89
½" DIA (12.7mm)	1.00
14.0mm DIA	1.23
⅞" DIA (14.287mm)	1.27
15.0mm DIA	1.40
⅝" DIA (15.875mm)	1.56
16.0mm DIA	1.59
1⅞" DIA (17.462mm)	1.91
18.0mm DIA	2.03
¾" DIA (19.05mm)	2.25
20.0mm DIA	2.48
⅞" DIA (22.225mm)	3.07
24.0mm DIA	3.60
25.0mm DIA	3.88
1" DIA (25.4mm)	4.00

continued...

Size	KG/Metre
1⅞" DIA (28.575mm)	5.07
30.0mm DIA	5.58
1¼" DIA (31.75mm)	6.25
32.0mm DIA	6.40
1⅜" DIA (34.925mm)	7.57
35.0mm DIA	7.60
1½" DIA (38.1mm)	9.01
40.0mm DIA	9.93
1⅝" DIA (41.275mm)	10.6
1¾" DIA (44.45mm)	12.3
1⅞" DIA (47.625mm)	14.2
45.0mm DIA	12.7
50.0mm DIA	15.5
2" DIA (50.8mm)	16.0
2⅞" DIA (53.975mm)	18.2
2¼" DIA (57.15mm)	20.3
60.0mm DIA	22.3
2⅝" DIA (60.325mm)	22.8
2½" DIA (63.5mm)	25.0
2⅞" DIA (66.67mm)	27.8
2¾" DIA (69.85mm)	30.3
3" DIA (76.2mm)	36.0
3¼" DIA (82.55mm)	42.9
3½" DIA (88.9mm)	49.8
3¾" DIA (95.25mm)	57.1
4" DIA (101.6mm)	65.0
4¼" DIA (107.95mm)	73.4

continued...

Size	KG/Metre
4½" DIA (114.3mm)	82.3
4¾" DIA (120.65mm)	92.4
5" DIA (127.0mm)	102
5¼" DIA (133.35mm)	112
5½" DIA (139.7mm)	123
5¾" DIA (146.05mm)	134
6" DIA (152.4mm)	146
6¼" DIA (158.75mm)	159
6½" DIA (165.1mm)	172
7" DIA (177.8mm)	199
185.0mm DIA	217
7½" DIA (190.5mm)	229
8" DIA (203.2mm)	260
8½" DIA (215.9mm)	294
9" DIA (228.6mm)	329
9½" DIA (241.3mm)	369
10" DIA (254.0mm)	406
10½" DIA (266.7mm)	451
11" DIA (279.4mm)	492
12" DIA (304.8mm)	585
340.0mm DIA	728
14" DIA (355.6mm)	802
16" DIA (406.4mm)	1040

# Stainless Steel

## Hexagon Bar

Stainless Steel Hexagon Bar Grade 1.4305 (303)

Size	KG/Metre
0.3125" A/F	0.43
0.437" A/F	0.84
0.500" A/F	1.10
0.562" A/F	1.39
0.625" A/F	1.73
0.750" A/F	2.48
0.820" A/F	2.97
0.875" A/F	3.38
0.937" A/F	3.88
1.010" A/F	4.50
1.125" A/F	5.59
1.250" A/F	6.90



Stainless Steel Hexagon Bar Grade 1.4404 (316L)

Size	KG/Metre
0.500" A/F	1.11
0.562" A/F	1.40
0.625" A/F	1.74
17.0mm A/F	1.99
0.750" A/F	2.50
0.820" A/F	2.99
0.875" A/F	3.41
0.920" A/F	3.76
1.010" A/F	4.54
1.101" A/F	5.39
1.125" A/F	5.63
1.200" A/F	6.40
1.250" A/F	6.95
1.300" A/F	7.52
1.375" A/F	8.41
1.480" A/F	9.74
1.500" A/F	10.0
1.670" A/F	12.4
1.860" A/F	15.4
2.500" A/F	27.8

## Square Bar

Stainless Steel Hot Rolled Square Bar Grade 1.4307/304L

Size	KG/Metre
12.0mm SQ	1.14
16.0mm SQ	2.02
20.0mm SQ	3.16
25.0mm SQ	4.94
30.0mm SQ	7.11
40.0mm SQ	12.64
50.0mm SQ	19.75



Stainless Steel Hot Rolled Square Bar Grade 1.4404/316L

Size	KG/Metre
12.0mm SQ	1.15
16.0mm SQ	2.04
20.0mm SQ	3.18
25.0mm SQ	4.98
30.0mm SQ	7.16
1½" SQ	11.55
40.0mm SQ	12.74
50.0mm SQ	19.90

# Stainless Steel

## Flat Bar - Hot Rolled

Stainless Steel Hot Rolled Flat Bar Grade 1.4307  
(304L)

Size	KG/Metre
20.0mm X 10.0mm	1.58
20.0mm X 12.0mm	1.90
25.0mm X 10.0mm	1.98
25.0mm X 12.0mm	2.37
25.0mm X 15.0mm	2.96
25.0mm X 20.0mm	3.95
30.0mm X 12.0mm	2.84
30.0mm X 15.0mm	3.56
30.0mm X 25.0mm	5.93
40.0mm X 15.0mm	4.74
40.0mm X 20.0mm	6.32
40.0mm X 25.0mm	7.90
50.0mm X 15.0mm	5.93
50.0mm X 20.0mm	7.90
50.0mm X 25.0mm	9.88
60.0mm X 15.0mm	7.11
60.0mm X 20.0mm	9.48
60.0mm X 25.0mm	11.9
75.0mm X 15.0mm	8.89
75.0mm X 20.0mm	11.9
75.0mm X 25.0mm	14.8
100.0mm X 15.0mm	11.9
100.0mm X 20.0mm	15.8
100.0mm X 25.0mm	19.8

Stainless Steel Hot Rolled Flat Bar Grade 1.4404  
(316L)

Size	KG/Metre
20.0mm X 10.0mm	1.59
20.0mm X 12.0mm	1.91
25.0mm X 10.0mm	1.99
25.0mm X 12.0mm	2.39
25.0mm X 15.0mm	2.99
30.0mm X 12.0mm	2.87
30.0mm X 20.0mm	4.78
30.0mm X 25.0mm	5.97
40.0mm X 15.0mm	4.78
40.0mm X 20.0mm	6.37
40.0mm X 25.0mm	7.96
50.0mm X 15.0mm	5.97
50.0mm X 20.0mm	7.96
50.0mm X 25.0mm	9.95
60.0mm X 15.0mm	7.16
60.0mm X 20.0mm	9.55
75.0mm X 20.0mm	11.94
100.0mm X 15.0mm	11.94



# Stainless Steel

## Flat Bar - Rolled Edge

Stainless Steel Rolled Edge Flat Bar Grades 1.4307 (304L) & 1.4404 (316L)



Size	KG/Metre
12.0mm X 3.0mm	0.28
12.0mm X 5.0mm	0.47
12.0mm X 6.0mm	0.57
20.0mm X 3.0mm	0.47
20.0mm X 5.0mm	0.79
20.0mm X 6.0mm	0.95
25.0mm X 3.0mm	0.59
25.0mm X 5.0mm	0.99
25.0mm X 6.0mm	1.19
25.0mm X 8.0mm	1.58
25.0mm X 10.0mm	1.98
30.0mm X 3.0mm	0.71
30.0mm X 5.0mm	1.19
30.0mm X 6.0mm	1.42
30.0mm X 8.0mm	1.90
30.0mm X 10.0mm	2.37
35.0mm X 6.0mm	1.66
40.0mm X 3.0mm	0.95
40.0mm X 5.0mm	1.58
40.0mm X 6.0mm	1.90
40.0mm X 8.0mm	2.53
40.0mm X 10.0mm	3.16
40.0mm X 12.0mm	3.79
45.0mm X 6.0mm	2.13
50.0mm X 3.0mm	1.19
50.0mm X 5.0mm	1.98
50.0mm X 6.0mm	2.37

continued...

Size	KG/Metre
50.0mm X 8.0mm	3.16
50.0mm X 10.0mm	3.95
50.0mm X 12.0mm	4.74
60.0mm X 3.0mm	1.42
60.0mm X 5.0mm	2.37
60.0mm X 6.0mm	2.84
60.0mm X 8.0mm	3.79
60.0mm X 10.0mm	4.74
60.0mm X 12.0mm	5.69
65.0mm X 6.0mm	3.08
65.0mm X 10.0mm	5.14
75.0mm X 3.0mm	1.78
75.0mm X 5.0mm	2.96
75.0mm X 6.0mm	3.56
75.0mm X 8.0mm	4.74
75.0mm X 10.0mm	5.93
75.0mm X 12.0mm	7.11
80.0mm X 6.0mm	3.79
80.0mm X 10.0mm	6.32
100.0mm X 3.0mm	2.37
100.0mm X 5.0mm	3.95
100.0mm X 6.0mm	4.74
100.0mm X 8.0mm	6.32
100.0mm X 10.0mm	7.90
100.0mm X 12.0mm	9.48
125.0mm X 6.0mm	5.93
125.0mm X 10.0mm	9.88

continued...

Size	KG/Metre
125.0mm X 12.0mm	11.85
150.0mm X 6.0mm	7.11
150.0mm X 8.0mm	9.48
150.0mm X 10.0mm	11.85
150.0mm X 12.0mm	14.33
200.0mm X 6.0mm	9.48
200.0mm X 8.0mm	12.64
200.0mm X 10.0mm	15.80



# Stainless Steel

## Structural & Decorative Tube - Round

Stainless Steel Welded Structural & Decorative Tube  
Grades 304 & 316 - Mirror Polish O/D

Size	KG/Metre
5/8" OD X 1.2mm	0.44
5/8" OD X 1.5mm	0.54
1/2" OD X 1.5mm	0.42
3/4" OD X 18SWG	0.54
3/4" OD X 1.5mm	0.65
7/8" OD X 1.2mm	0.63
7/8" OD X 1.5mm	0.77
7/8" OD X 2.0mm	1.00
19mm OD X 1.2mm	0.53
1" OD X 1.2mm	0.72
1" OD X 1.5mm	0.89
1" OD X 2.0mm	1.17
1 1/4" OD X 1.2mm	0.91
1 1/4" OD X 1.5mm	1.13
1 1/2" OD X 1.2mm	1.10
1 1/2" OD X 1.5mm	1.40
1 1/2" OD X 2.0mm	1.80
1 3/4" OD X 1.5mm	1.60
2" OD X 1.2mm	1.48
2" OD X 1.5mm	1.84
2" OD X 2.0mm	2.44
2" OD X 3.0mm	3.56
2 1/2" OD X 1.5mm	2.31
3" OD X 1.5mm	2.78

Stainless Steel Welded Structural & Decorative Tube  
Grades 304 & 316 - Brushed Finish O/D

Size	KG/Metre
3/4" OD X 1.5mm	0.65
1" OD X 1.5mm	0.89
1 1/2" OD X 1.5mm	1.36
1 1/2" OD X 2.0mm	1.79
1 1/2" OD X 3.0mm	2.61
2" OD X 1.5mm	1.84
2" OD X 2.0mm	2.42
2" OD X 3.0mm	3.56
3" OD X 3.0mm	5.45
4" OD X 3.0mm	7.34

Stainless Steel Welded Structural & Decorative Tube  
ASTM A554 Grades 304 & 316 - Satin Polish O/D

Size	KG/Metre
1 1/2" OD X 3.0mm SATIN	2.63
2" OD X 3.0mm SATIN	3.59
3" OD X 3.0mm SATIN	5.49
4" OD X 3.0mm SATIN	7.40

Stainless Steel Welded Structural & Decorative Tube  
Grades 304 & 316 - Dull Polish O/D

Size	KG/Metre
3/4" OD X 1.5mm	0.65
1" OD X 1.5mm	0.89
1 1/2" OD X 1.5mm	1.36
1 1/2" OD X 2.0mm	1.79
1 1/2" OD X 3.0mm	2.61
2" OD X 1.5mm	1.84
2" OD X 2.0mm	2.42
2" OD X 3.0mm	3.56
3" OD X 3.0mm	5.45
4" OD X 3.0mm	7.34

Stainless Steel Welded Structural & Decorative Tube  
Grade 304 - Descaled Finish

Size	KG/Metre
25mm OD X 1.5mm	0.90
25mm OD X 2.0mm	1.14



# Stainless Steel

## Structural & Decorative Tube - Square

Stainless Steel Welded Structural & Decorative Tube  
Grade 1.4301 (304) - Dull Polish O/D

Size	KG/Metre
12.7mm X 12.7mm X 1.2mm	0.45
12.7mm X 12.7mm X 1.5mm	0.55
15mm X 15mm X 1.2mm	0.53
15mm X 15mm X 1.5mm	0.66
20mm X 20mm X 1.2mm	0.72
20mm X 20mm X 1.5mm	0.88
20mm X 20mm X 2.0mm	1.19
25mm X 25mm X 1.2mm	0.93
25mm X 25mm X 1.5mm	1.15
25mm X 25mm X 2.0mm	1.50
25mm X 25mm X 3.0mm	2.21
30mm X 30mm X 1.2mm	1.11
30mm X 30mm X 1.5mm	1.37
30mm X 30mm X 2.0mm	1.84
30mm X 30mm X 3.0mm	2.72
40mm X 40mm X 1.2mm	1.50
40mm X 40mm X 1.5mm	1.86
40mm X 40mm X 2.0mm	2.45
40mm X 40mm X 3.0mm	3.76
50mm X 50mm X 1.5mm	2.33
50mm X 50mm X 2.0mm	3.08
50mm X 50mm X 3.0mm	4.65
60mm X 60mm X 2.0mm	3.71
60mm X 60mm X 3.0mm	5.49
70mm X 70mm X 3.0mm	6.53
80mm X 80mm X 2.0mm	4.99

Size	KG/Metre
80mm X 80mm X 3.0mm	7.53
100mm X 100mm X 2.0mm	6.40
100mm X 100mm X 3.0mm	9.53

Stainless Steel Welded Structural & Decorative Tube  
Grade 1.4301 (304) - Descaled Finish

Size	KG/Metre
12.7mm X 12.7mm X 1.2mm	0.45
12.7mm X 12.7mm X 1.5mm	0.55
40mm X 40mm X 4.0mm	4.81
50mm X 50mm X 4.0mm	5.96
50mm X 50mm X 5.0mm	7.41
60mm X 60mm X 4.0mm	7.22
60mm X 60mm X 5.0mm	8.90
80mm X 80mm X 4.0mm	9.82
80mm X 80mm X 5.0mm	12.40
100mm X 100mm X 4.0mm	12.40
100mm X 100mm X 5.0mm	15.38
100mm X 100mm X 6.0mm	17.50
100mm X 100mm X 8.0mm	23.26
120mm X 120mm X 3.0mm	11.80
120mm X 120mm X 4.0mm	15.00
120mm X 120mm X 5.0mm	18.66
120mm X 120mm X 6.0mm	21.20
150mm X 150mm X 3.0mm	14.06



Stainless Steel Welded Structural & Decorative Tube  
Grade 1.4301 (304) - Brushed Finish O/D

Size	KG/Metre
150mm X 150mm X 4.0mm	18.62
150mm X 150mm X 5.0mm	22.40
150mm X 150mm X 6.0mm	27.36
150mm X 150mm X 8.0mm	34.30
150mm X 150mm X 10.0mm	41.65
200mm X 200mm X 3.0mm	18.62
200mm X 200mm X 5.0mm	30.40
200mm X 200mm X 6.0mm	36.09
200mm X 200mm X 8.0mm	47.10
200mm X 200mm X 10.0mm	57.60

Stainless Steel Welded Structural & Decorative Tube  
Grade 1.4404 (316) - Descaled Finish

Size	KG/Metre
80mm X 80mm X 4.0mm	9.82
100mm X 100mm X 4.0mm	12.40
100mm X 100mm X 5.0mm	15.38
100mm X 100mm X 6.0mm	17.50
100mm X 100mm X 8.0mm	21.60
120mm X 120mm X 4.0mm	14.77
120mm X 120mm X 5.0mm	18.66
120mm X 120mm X 6.0mm	21.20
150mm X 150mm X 4.0mm	18.60
150mm X 150mm X 5.0mm	23.08
150mm X 150mm X 6.0mm	27.51

continued...

# Stainless Steel

## Structural & Decorative Tube - Square

Stainless Steel Welded Structural & Decorative Tube  
Grade 1.4016 (430) - Dull Polish O/D

Size	KG/Metre
20mm X 20mm X 1.5mm	0.88
25mm X 25mm X 1.5mm	1.15
25mm X 25mm X 2.0mm	1.50
30mm X 30mm X 1.5mm	1.37
30mm X 30mm X 2.0mm	1.84
30mm X 30mm X 3.0mm	2.72
40mm X 40mm X 1.5mm	1.86
40mm X 40mm X 2.0mm	2.45
40mm X 40mm X 3.0mm	3.76
50mm X 50mm X 1.5mm	2.33
50mm X 50mm X 2.0mm	3.08
50mm X 50mm X 3.0mm	4.65
60mm X 60mm X 3.0mm	5.44
80mm X 80mm X 3.0mm	7.36
100mm X 100mm X 3.0mm	9.53
100mm X 100mm X 4.0mm	12.40

Stainless Steel Welded Structural & Decorative Tube  
Grade 1.4016 (430) - Dull Polish O/D

Size	KG/Metre
25mm X 25mm X 1.2mm	0.93
30mm X 30mm X 1.2mm	1.11
30mm X 30mm X 1.5mm	1.37
40mm X 40mm X 1.5mm	1.86

Stainless Steel Welded Structural & Decorative Tube  
Grade 1.4301 (304) - Brushed Finish O/D

Size	KG/Metre
20mm X 20mm X 1.5mm	0.88

Stainless Steel Welded Structural & Decorative Tube  
to EN/ISO 1127 Grade 1.4509 (441) - Dull Polish O/D

Size	KG/Metre
25mm X 25mm X 1.2mm	0.93
30mm X 30mm X 1.2mm	1.11
30mm X 30mm X 1.5mm	1.37
40mm X 40mm X 1.5mm	1.86



# Stainless Steel

## Structural & Decorative Tube - Rectangular



Stainless Steel Welded Structural & Decorative Tube  
Grade 304 - Descaled Finish

Size	KG/Metre
80mm X 40mm X 4.0mm	7.22
80mm X 40mm X 5.0mm	8.90
100mm X 50mm X 4.0mm	9.09
100mm X 50mm X 5.0mm	11.2
120mm X 60mm X 3.0mm	8.39
120mm X 60mm X 4.0mm	11.1
120mm X 60mm X 5.0mm	13.8
120mm X 80mm X 3.0mm	9.53
120mm X 80mm X 4.0mm	12.4
120mm X 80mm X 5.0mm	15.4
150mm X 50mm X 3.0mm	9.53
150mm X 50mm X 5.0mm	15.4
150mm X 100mm X 3.0mm	11.7
150mm X 100mm X 4.0mm	15.4
150mm X 100mm X 5.0mm	18.8
150mm X 100mm X 6.0mm	22.6
150mm X 100mm X 8.0mm	27.9
200mm X 100mm X 3.0mm	14.1
200mm X 100mm X 4.0mm	18.6
200mm X 100mm X 5.0mm	22.4
200mm X 100mm X 6.0mm	27.4
200mm X 100mm X 8.0mm	35.9
200mm X 100mm X 10.0mm	41.6
250mm X 150mm X 6.0mm	36.8
250mm X 150mm X 8.0mm	47.3

Stainless Steel Welded Structural & Decorative Tube  
Grade 304 - Dull Polish O/D

Size	KG/Metre
20mm X 10mm X 1.5mm	0.66
30mm X 10mm X 1.2mm	0.73
30mm X 10mm X 1.5mm	0.90
30mm X 15mm X 1.5mm	1.00
30mm X 20mm X 1.5mm	1.15
40mm X 15mm X 1.5mm	1.26
40mm X 20mm X 1.2mm	1.11
40mm X 20mm X 1.5mm	1.37
40mm X 20mm X 2.0mm	1.84
50mm X 25mm X 1.2mm	1.42
50mm X 25mm X 1.5mm	1.76
50mm X 25mm X 2.0mm	2.32
50mm X 25mm X 3.0mm	3.46
50mm X 30mm X 1.5mm	1.86
50mm X 30mm X 2.0mm	2.45
50mm X 30mm X 3.0mm	3.76
60mm X 20mm X 1.5mm	1.86
60mm X 30mm X 1.5mm	2.12
60mm X 30mm X 2.0mm	2.80
60mm X 30mm X 3.0mm	4.13
60mm X 40mm X 1.5mm	2.33
60mm X 40mm X 2.0mm	3.08
60mm X 40mm X 3.0mm	4.65
80mm X 40mm X 1.5mm	2.80
80mm X 40mm X 2.0mm	3.71
80mm X 40mm X 3.0mm	5.49

Size	KG/Metre
80mm X 60mm X 3.0mm	6.53
100mm X 50mm X 2.0mm	4.68
100mm X 40mm X 3.0mm	6.53
100mm X 50mm X 3.0mm	6.95
100mm X 60mm X 3.0mm	7.53
120mm X 60mm X 3.0mm	8.39

continued...

# Stainless Steel

## Structural & Decorative Tube - Rectangular

Stainless Steel Welded Structural & Decorative Tube  
Grade 316 - Descaled finish

Size	KG/Metre
80mm X 40mm X 4.0mm	7.2
80mm X 40mm X 5.0mm	8.9
100mm X 50mm X 5.0mm	11.1
120mm X 80mm X 3.0mm	9.5
120mm X 80mm X 5.0mm	15.4
150mm X 100mm X 3.0mm	11.7
150mm X 100mm X 4.0mm	15.4
150mm X 100mm X 5.0mm	19.1
150mm X 100mm X 6.0mm	22.6
150mm X 100mm X 8.0mm	29.8
200mm X 100mm X 4.0mm	18.6
200mm X 100mm X 5.0mm	23.1
200mm X 100mm X 6.0mm	27.5
200mm X 100mm X 8.0mm	34.3

Stainless Steel Welded Structural & Decorative Tube  
Grade 316 - Dull Polish O/D

Size	KG/Metre
40mm X 20mm X 1.5mm	1.37
50mm X 25mm X 1.5mm	1.76
60mm X 40mm X 2.0mm	3.06
80mm X 40mm X 2.0mm	3.71
80mm X 40mm X 3.0mm	5.49
100mm X 50mm X 2.0mm	4.68
100mm X 50mm X 3.0mm	6.95



# Stainless Steel

## Pipe



SEAMLESS TO ASTM A312 / ANSI B36.19

Size	304L	316L
1/8" SCH10S		0.28
1/8" SCH40S		0.37
1/4" SCH10S		0.50
1/4" SCH40S	0.64	0.64
1/4" SCH80S	0.81	0.81
3/8" SCH10S	0.64	0.64
3/8" SCH40S	0.86	0.86
3/8" SCH80S		1.12
1/2" SCH10S	1.02	1.02
1/2" SCH40S	1.29	1.29
1/2" SCH80S	1.65	1.65
3/4" SCH10S		1.30
3/4" SCH40S	1.72	1.72
3/4" SCH80S	2.24	2.24
1" SCH10S	2.13	2.13
1" SCH40S	2.55	2.55
1" SCH80S	3.30	3.30
1 1/4" SCH40S	3.45	
1 1/4" SCH80S	4.55	4.55
1 1/2" SCH5S	1.93	
1 1/2" SCH10S	3.16	3.16
1 1/2" SCH40S	4.12	4.12
1 1/2" SCH80S	5.51	5.51
2" SCH10S	4.00	4.00
2" SCH40S	5.54	5.54
2" SCH80S	7.62	7.62

continued...

SEAMLESS TO ASTM A312 / ANSI B36.10 Grade 316L

Size	304L	316L
2 1/2" SCH10S	5.36	5.36
2 1/2" SCH40S	8.79	8.79
2 1/2" SCH80S		11.60
3" SCH10S	6.57	6.57
3" SCH40S	11.50	11.50
3" SCH80S	15.60	15.60
4" SCH10S	8.52	8.52
4" SCH40S	16.40	16.40
4" SCH80S	22.70	22.70
5" SCH40S		22.20
6" SCH10S	14.10	
6" SCH40S	28.80	
6" SCH80S	43.40	43.40
8" SCH10S		20.30
8" SCH40S	43.30	43.30

Size	KG/Metre
1/2" SCH160	1.99
3/4" SCH160	2.95
1" SCH160	4.32
1 1/2" SCH160	7.37
2" SCH160	11.30
3" SCH160	21.70
6" SCH10S	14.10
6" SCH40S	28.80
8" SCH80S	65.90

# Stainless Steel

## Pipe

WELDED TO ASTM A312 / ANSI B36.19



Size	304L	316L
½" SCH5S	0.82	0.82
½" SCH10S	1.02	1.02
½" SCH40S	1.29	1.29
¾" SCH5S	1.04	1.04
¾" SCH10S	1.30	1.30
¾" SCH40S	1.72	1.72
1" SCH5S	1.32	1.32
1" SCH10S	2.13	2.13
1" SCH40S	2.55	2.55
1¼" SCH5S	1.68	
1¼" SCH10S	2.74	2.74
1¼" SCH40S	3.45	3.45
1½" SCH5S		1.93
1½" SCH10S	3.16	3.16
1½" SCH40S	4.11	4.11
2" SCH5S	2.43	2.43
2" SCH10S	4.00	4.00
2" SCH40S	5.54	5.54
2½" SCH5S	3.76	3.76
2½" SCH10S	5.36	5.36
2½" SCH40S	8.79	8.79
3" SCH5S	4.60	4.60
3" SCH10S	6.57	6.57
3" SCH40S	11.50	11.50
3½" SCH10S	7.55	7.55
3½" SCH40S	13.80	13.80

Size	304L	316L
4" SCH5S	5.94	5.94
4" SCH10S	8.52	8.52
4" SCH40S	16.40	16.40
5" SCH10S	11.80	11.80
5" SCH40S	22.20	22.20
6" SCH5S	11.50	11.50
6" SCH10S	14.10	14.10
6" SCH40S	28.80	28.80
8" SCH5S	15.10	15.10
8" SCH10S	20.30	20.30
8" SCH40S	43.30	43.30
10" SCH5S		23.10
10" SCH10S	28.30	28.30
10" SCH40S	61.40	61.40
12" SCH5S		31.90
12" SCH10S	36.70	36.70
12" SCH40S	75.20	75.20
14" SCH10S	42.10	42.10
16" SCH10S	48.20	48.20
18" SCH10S	54.30	54.30
20" SCH10S	69.90	69.90
24" SCH10S	96.20	96.20

continued...

# Stainless Steel

## Butt Weld Fittings



Stainless Steel Equal Tees - Seamless

Size	304L	316L
½" SCH10S EQUAL TEE		0.06
½" SCH40S EQUAL TEE	0.07	0.07
1" SCH10S EQUAL TEE	0.18	0.18
1" SCH40S EQUAL TEE	0.21	0.21
1½" SCH10S EQUAL TEE	0.40	0.40
1½" SCH40S EQUAL TEE		0.52
2" SCH10S EQUAL TEE	0.56	0.56
2" SCH40S EQUAL TEE	0.77	0.77
3" SCH10S EQUAL TEE		1.24
3" SCH40S EQUAL TEE		2.17
4" SCH10S EQUAL TEE	1.96	1.96
4" SCH80S EQUAL TEE		5.24
6" SCH10S EQUAL TEE	4.43	4.43

Stainless Steel Reducing Tees - Seamless

Size	304L	316L
1"-½" SCH10S RED TEE	0.18	0.18
1½-½" SCH10S RED TEE		0.65
1½-¾" SCH10S RED TEE		0.14
1½"-1" SCH40S RED TEE		0.52
2"-1" SCH10S RED TEE		0.56
2"-1" SCH40S RED TEE		0.77
3"-2" SCH10S RED TEE		1.24
4"-2" SCH10S RED TEE	1.96	



Stainless Steel Long Radius Elbows - 90 Degree - Seamless

Size	304L	316L
½" SCH10S 90 LR ELBOW	0.06	0.06
½" SCH40S 90 LR ELBOW	0.08	0.08
1" SCH80S 90 LR ELBOW		0.10
¾" SCH10S 90 LR ELBOW	0.06	0.06
¾" SCH40S 90 LR ELBOW		0.08
¾" SCH80S 90 LR ELBOW		0.10
1" SCH10S 90 LR ELBOW	0.13	0.13
1" SCH40S 90 LR ELBOW	0.15	0.15
1" SCH80S 90 LR ELBOW		0.20
1½" SCH10S 90 LR ELBOW	0.28	0.28
1½" SCH40S 90 LR ELBOW	0.37	0.37
1½" SCH80S 90 LR ELBOW		0.49
2" SCH10S 90 LR ELBOW	0.48	0.48
2" SCH40S 90 LR ELBOW	0.66	0.66
2" SCH80S 90 LR ELBOW		0.91
2½" SCH10S 90 LR ELBOW	0.80	0.80
3" SCH10S 90 LR ELBOW	1.18	1.18
3" SCH40S 90 LR ELBOW	2.07	2.07
4" SCH10S 90 LR ELBOW	2.04	2.04
4" SCH40S 90 LR ELBOW	3.92	3.92
6" SCH10S 90 LR ELBOW	5.06	5.06
6" SCH40S 90 LR ELBOW		10.35
8" SCH10S 90 LR ELBOW	9.74	



Stainless Steel Long Radius 45 Degree Elbows - Seamless

Size	304L	316L
½" SCH40S 45 LR ELBOW		0.04
1" SCH10S 45 LR ELBOW		0.06
1½" SCH10S 45 LR ELBOW		0.14
1½" SCH40S 45 LR ELBOW		0.18
2" SCH10S 45 LR ELBOW		0.24
2" SCH40S 45 LR ELBOW		0.33



Stainless Steel End Caps - Seamless

Size	304L	316L
½" SCH10S END CAP		0.03
1" SCH10S END CAP	0.07	0.07
1" SCH40S END CAP		0.10
1¼" SCH10S END CAP		0.10
1½" SCH10S END CAP	0.13	0.13
2" SCH10S END CAP	0.19	0.19
2½" SCH40S END CAP	0.37	
3" SCH10S END CAP	0.38	0.38
3" SCH40S END CAP		0.64
4" SCH10S END CAP	0.57	0.57
6" SCH10S END CAP		1.41
8" SCH40S END CAP		5.08
12" SCH10S END CAP		6.68



# Stainless Steel

## Butt Weld Fittings



Stainless Steel Concentric Reducers - Seamless

Size	304L	316L
1"-½" SCH10S CON-RED		0.11
1"-½" SCH40S CON-RED		0.13
1½"-1" SCH10S CON-RED	0.20	0.20
1½"-1" SCH40S CON-RED		0.26
1½"-1¼" SCH40S CON-RED		0.26
2"-1" SCH10S CON-RED	0.30	0.30
2"-1" SCH40S CON-RED	0.42	0.42
2"-1½" SCH10S CON-RED		0.30
2"-1½" SCH40S CON-RED		0.42
3"-1½" SCH40S CON-RED		1.02
3"-2" SCH10S CON-RED		0.58
3"-2" SCH40S CON-RED		1.02
4"-2" SCH10S CON-RED	0.87	0.87
4"-2" SCH40S CON-RED		1.66
4"-3" SCH10S CON-RED	0.87	0.87
6"-3" SCH10S CON-RED		1.97
6"-4" SCH10S CON-RED		1.97

Stainless Steel Eccentric Reducers - Seamless

Size	304L	316L
1½"-1" SCH10S ECC-RED		0.18
4"-3" SCH10S ECC-RED		0.87



Stainless Steel Short Radius Elbows - 90 Degree-Seamless (ANSI B16.28)

Size	304L	316L
1½" SCH40S 90 SR ELBOW		0.25
2" SCH10S 90 SR ELBOW		0.32
2" SCH40S 90 SR ELBOW		0.44
3" SCH10S 90 SR ELBOW		0.79
3" SCH40S 90 SR ELBOW		1.38
4" SCH10S 90 SR ELBOW		1.36
4" SCH40S 90 SR ELBOW		2.60
6" SCH10S 90 SR ELBOW		5.45



Stainless Steel Stub Ends Type A MSS SP43 Seamless

Size	304L	316L
1" SCH10S STUB TYPE A		0.14
1½" SCH10S STUB TYPE A		0.25
2" SCH10S STUB TYPE A	0.38	0.38
3" SCH10S STUB TYPE A		0.64
4" SCH10S STUB TYPE A		0.98
6" SCH10S STUB TYPE A		1.95

# Stainless Steel

## Butt Weld Fittings



Stainless Steel Equal Tees - Welded

Size	304L	316L
½" SCH10S EQUAL TEE	0.06	0.06
¾" SCH10S EQUAL TEE	0.08	0.08
1" SCH10S EQUAL TEE	0.18	0.18
1" SCH40S EQUAL TEE	0.21	0.21
1½" SCH10S EQUAL TEE	0.40	0.40
1½" SCH40S EQUAL TEE	0.52	0.52
2" SCH10S EQUAL TEE	0.56	0.56
2" SCH40S EQUAL TEE	0.77	0.77
3" SCH10S EQUAL TEE	1.24	1.24
4" SCH10S EQUAL TEE	1.96	1.96
6" SCH10S EQUAL TEE	4.43	

Stainless Steel Reducing Tees - Welded

Size	304L	316L
1"-½" SCH10S RED TEE		0.18
1½"-1" SCH10S RED TEE	0.40	0.40
2"-1" SCH10S RED TEE	0.56	0.56
2"-1½" SCH10S RED TEE	0.56	
3"-1½" SCH10S RED TEE	1.24	
3"-2" SCH10S RED TEE	1.24	1.24



Stainless Steel Long Radius 90 Degree Elbows - Welded

Size	304L	316L
½" SCH10S 90 LR ELBOW	0.06	0.06
¾" SCH40S 90 LR ELBOW	0.08	0.08
¾" SCH10S 90 LR ELBOW	0.06	0.06
¾" SCH40S 90 LR ELBOW	0.08	0.08
1" SCH10S 90 LR ELBOW	0.13	0.13
1" SCH40S 90 LR ELBOW	0.15	0.15
1¼" SCH10S 90 LR ELBOW	0.21	0.21
1¼" SCH40S 90 LR ELBOW	0.26	
1½" SCH10S 90 LR ELBOW	0.28	0.28
1½" SCH40S 90 LR ELBOW		0.37
2" SCH10S 90 LR ELBOW	0.48	0.48
2" SCH40S 90 LR ELBOW	0.66	0.66
2½" SCH10S 90 LR ELBOW	0.80	0.80
3" SCH10S 90 LR ELBOW	1.18	1.18
3" SCH40S 90 LR ELBOW	2.07	2.07
4" SCH10S 90 LR ELBOW	2.04	2.04
4" SCH40S 90 LR ELBOW	3.92	3.92
6" SCH10S 90 LR ELBOW	5.06	5.06
6" SCH40S 90 LR ELBOW	10.35	10.35
8" SCH10S 90 LR ELBOW	9.74	9.74
8" SCH40S 90 LR ELBOW		20.76
10" SCH10S 90 LR ELBOW	16.95	16.95
12" SCH10S 90 LR ELBOW	26.35	26.35
12" SCH40S 90 LR ELBOW		54.04
14" SCH10S 90 LR ELBOW		35.28
16" SCH10S 90 LR ELBOW		46.10
20" SCH10S 90 LR ELBOW		83.70



Stainless Steel Long Radius 45 Degree Elbows - Welded

Size	304L	316L
¾" SCH40S 45 LR ELBOW	0.03	0.04
1" SCH10S 45 LR ELBOW		0.06
1" SCH40S 45 LR ELBOW		0.08
1½" SCH10S 45 LR ELBOW	0.14	0.14
1½" SCH40S 45 LR ELBOW		0.18
2" SCH10S 45 LR ELBOW	0.24	0.24
3" SCH10S 45 LR ELBOW	0.59	0.59
4" SCH10S 45 LR ELBOW	1.02	1.02
6" SCH10S 45 LR ELBOW	2.53	2.53
8" SCH10S 45 LR ELBOW		4.87
10" SCH10S 45 LR ELBOW		8.47

# Stainless Steel

## Butt Weld Fittings

### Stainless Steel Concentric Reducers - Welded

Size	304L	316L
1"-½" SCH10S CON-RED	0.11	0.11
1"-½" SCH40S CON-RED		0.13
1"-¾" SCH10S CON-RED		0.11
1½"-1" SCH10S CON-RED	0.20	0.20
1½"-1" SCH40S CON-RED		0.26
2"-1" SCH10S CON-RED	0.30	0.30
2"-1½" SCH10S CON-RED	0.30	0.30
2"-1½" SCH40S CON-RED	0.42	0.42
2½"-2" SCH10S CON-RED		0.48
3"-1½" SCH10S CON-RED	0.58	0.58
3"-2" SCH10S CON-RED	0.58	0.58
3"-2" SCH40S CON-RED		1.02
3"-2½" SCH10S CON-RED		0.58
4"-2" SCH10S CON-RED	0.87	0.87
4"-3" SCH10S CON-RED	0.87	0.87
6"-3" SCH10S CON-RED	1.97	
6"-4" SCH10S CON-RED	1.97	1.97
8"-4" SCH10S CON-RED		3.10
8"-6" SCH10S CON-RED		3.10



### Stainless Steel Eccentric Reducers - Welded

Size	304L	316L
1½"-1" SCH10S ECC-RED		0.20
1½"-1" SCH40S ECC-RED		0.26
2½"-2" SCH10S ECC-RED		0.48
3"-1½" SCH10S ECC-RED		0.58
3"-2" SCH10S ECC-RED	0.58	
4"-2" SCH10S ECC-RED		0.87
4"-3" SCH10S ECC-RED		0.87



### Stainless Steel Stub Ends Type A MSS SP43 Welded

Size	304L	316L
½" SCH10S STUB TYPE A		0.08
1" SCH10S STUB TYPE A	0.14	0.14
1½" SCH10S STUB TYPE A	0.25	0.25
2" SCH10S STUB TYPE A	0.38	0.38
2½" SCH10S STUB TYPE A		0.47
3" SCH10S STUB TYPE A		0.64
4" SCH10S STUB TYPE A		0.98
6" SCH10S STUB TYPE A		1.95
8" SCH10S STUB TYPE A		3.11

# Stainless Steel

## High Pressure Fittings - Threaded

High Pressure 3000lb NPT Threaded Fittings to ANSI B16.11 in Grades 304L & 316L

Size Range: ½" to 3"



90° Elbow



45° Elbow



Equal Tee



Reducing Tee



Hexagon Plug



Cap



Full Coupling



Half Coupling



Union



Hexagon Nipple

For further information please see the full brochure on this range which can be downloaded from the Aalco web site at [www.aalco.co.uk](http://www.aalco.co.uk) or requested from your local Service Centre

# Stainless Steel

## High Pressure Fittings - Socket Weld

High Pressure 3000lb Socket Weld Fittings to ANSI B16.11 in Grades 304L & 316L

Size Range: ½" to 3"



90° Elbow



45° Elbow



Equal Tee



Reducing Tee



Full Coupling



Union



Cap

For further information please see the full brochure on this range which can be downloaded from the Aalco web site at [www.aalco.co.uk](http://www.aalco.co.uk) or requested from your local Service Centre

# Stainless Steel

## Flanges



Stainless Steel Raised Face Blind Flanges ASTM A182/  
ANSI B16.5 150lb Grades 304L & 316L

Size	KG/Unit
½" 150lb RF BLIND	0.42
¾" 150lb RF BLIND	0.61
1" 150lb RF BLIND	0.86
1½" 150lb RF BLIND	1.53
2" 150lb RF BLIND	2.42
2½" 150lb RF BLIND	3.94
3" 150lb RF BLIND	4.93
4" 150lb RF BLIND	7.00
6" 150lb RF BLIND	11.3
8" 150lb RF BLIND	19.6
10" 150lb RF BLIND	28.8
12" 150lb RF BLIND	43.2

Stainless Steel Raised Face Blind Flanges ASTM A182/  
ANSI B16.5 300lb Grade 316

Size	KG/Unit
¾" 300lb RF BLIND	1.11
1" 300lb RF BLIND	1.39
2" 300lb RF BLIND	3.18
3" 300lb RF BLIND	6.81
4" 300lb RF BLIND	11.50



Stainless Steel Raised Face Slip On Flanges ASTM  
A182/ANSI B16.5 150lb Grades 304L & 316L

Size	KG/Unit
½" 150lb RF SLIP ON	0.39
¾" 150lb RF SLIP ON	0.56
1" 150lb RF SLIP ON	0.78
1¼" 150lb RF SLIP ON	1.03
1½" 150lb RF SLIP ON	1.32
2" 150lb RF SLIP ON	2.06
2½" 150lb RF SLIP ON	3.28
3" 150lb RF SLIP ON	3.85
4" 150lb RF SLIP ON	5.30
5" 150lb RF SLIP ON	6.01
6" 150lb RF SLIP ON	7.45
8" 150lb RF SLIP ON	12.1
10" 150lb RF SLIP ON	16.5
12" 150lb RF SLIP ON	26.2
14" 150lb RF SLIP ON	34.6
16" 150lb RF SLIP ON	44.8

Stainless Steel Raised Face Slip On Flanges ASTM  
A182/ANSI B16.5 300lb Grade 316

Size	KG/Unit
1" 300lb RF SLIP ON	1.36
1½" 300lb RF SLIP ON	2.49
2" 300lb RF SLIP ON	2.87
3" 300lb RF SLIP ON	5.85
4" 300lb RF SLIP ON	9.61



Stainless Steel Raised Face Weld Neck Flanges ASTM  
A182/ANSI B16.5 150lb Grades 304L & 316L

Size	KG/Unit
½" 150lb RFWN SCH10S	0.48
½" 150lb RFWN SCH40S	0.48
¾" 150lb RFWN SCH40S	0.71
1" 150lb RFWN SCH10S	1.01
1" 150lb RFWN SCH40S	1.01
1½" 150lb RFWN SCH10S	1.72
1½" 150lb RFWN SCH40S	1.72
2" 150lb RFWN SCH10S	2.58
2" 150lb RFWN SCH40S	2.58
2½" 150lb RFWN SCH10S	4.11
2½" 150lb RFWN SCH40S	4.11
3" 150lb RFWN SCH10S	4.92
3" 150lb RFWN SCH40S	4.92
4" 150lb RFWN SCH10S	6.84
4" 150lb RFWN SCH40S	6.84
6" 150lb RFWN SCH10S	10.6
6" 150lb RFWN SCH40S	10.6
8" 150lb RFWN SCH10S	17.6
10" 150lb RFWN SCH10S	24.0
12" 150lb RFWN SCH10S	24.0

# Stainless Steel

## Flanges

Stainless Steel Raised Face Weld Neck Flanges ASTM A182/ANSI B16.5 300lb Grade 316

Size	KG/Unit
¾" 300lb RFWN SCH40S	1.26
1" 300lb RFWN SCH10S	1.52
1" 300lb RFWN SCH40S	1.52
2" 300lb RFWN SCH10S	3.40
2" 300lb RFWN SCH40S	3.40
3" 300lb RFWN SCH10S	4.92
3" 300lb RFWN SCH40S	6.93
4" 300lb RFWN SCH40S	11.20

Stainless Steel Plate Flanges BS10 Table E - Blind Grade 316L

Size	KG/Unit
1" NB TABLE E BLIND	0.52
1½" TABLE E BLIND	0.88
2" TABLE E BLIND	1.26
3" TABLE E BLIND	2.23
4" TABLE E BLIND	3.45
6" TABLE E BLIND	5.14

Stainless Steel Plate Flanges BS10 Table E - Slip On Grade 316L

Size	KG/Unit
½" TABLE E SLIP ON	0.30
¾" TABLE E SLIP ON	0.33
1" TABLE E SLIP ON	0.47
1½" TABLE E SLIP ON	0.75
2" TABLE E SLIP ON	1.03
3" TABLE E SLIP ON	1.65
4" TABLE E SLIP ON	2.40
6" TABLE E SLIP ON	5.14
8" TABLE E SLIP ON	7.50

Stainless Steel BS4504/BSEN 1092 Flanges PN16/105 Raised Face Blind Grades 304L & 316L

Size	KG/Unit
1" PN 16/105 RF BLIND	1.30
1½" PN 16/105 RF BLIND	2.30
2" PN 16/105 RF BLIND	3.00
3" PN 16/105 RF BLIND	5.10
4" PN 16/105 RF BLIND	6.00
6" PN 16/105 RF BLIND	11.10

Stainless Steel BS4504/BSEN 1092 Flanges PN16/101 Raised Face Slip On Grades 304L & 316L

Size	KG/Unit
½" PN 16/101 RF S.O.	0.75
¾" PN 16/101 RF S.O.	0.90
1" PN 16/101 RF S.O.	1.10
1¼" PN 16/101 RF S.O.	1.70
1½" PN 16/101 RF S.O.	2.00
2" PN 16/101 RF S.O.	2.60
2½" PN 16/101 RF S.O.	3.20
3" PN 16/101 RF S.O.	4.10
4" PN 16/101 RF S.O.	4.40
6" PN 16/101 RF S.O.	7.20
8" PN 16/101 RF S.O.	9.90
10" PN 16/101 RF S.O.	14.30



# Stainless Steel

## Metric Tube and Fittings

Stainless Steel Metric Welded Tube EN10217-7-2006 TC1 Grades 304L & 316L

Size	KG/Metre
28mm O/D X 1.5MM WALL	0.99
38MM O/D X 1.5MM WALL	1.37
43MM O/D X 1.5MM WALL	1.56
44.5MM O/D X 2.0MM WALL	2.13
53MM O/D X 1.5MM WALL	1.93
54MM O/D X 2.0MM WALL	2.40
83MM O/D X 1.5MM WALL	3.06
84MM O/D X 2.0MM WALL	3.90
103MM O/D X 1.5MM WALL	3.81
104MM O/D X 2.0MM WALL	5.12
129 MM O/D 2.0MM WALL	6.35
153MM O/D X 1.5MM WALL	5.68
154MM O/D X 2.0MM WALL	7.60
204MM O/D X 2.0MM WALL	10.1
254MM O/D X 2.0MM WALL	15.8
304MM O/D X 2.0MM WALL	15.1

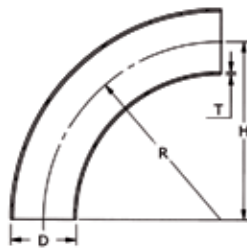

Welded 45° & 90° elbows (radius D+100)

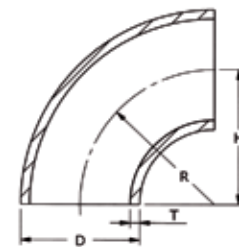

Welded 45° & 90° elbows (radius 1.5D)

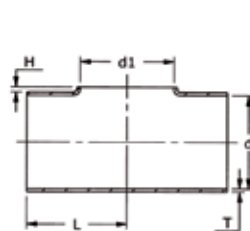

Pulled equal and reducing tees

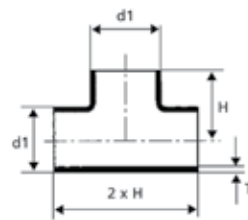

Equal tees with branch

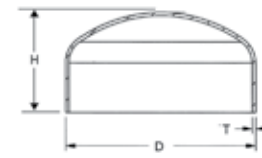

Pressed end caps

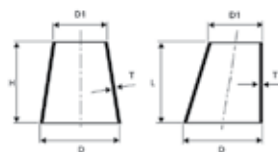

Concentric and eccentric reducers

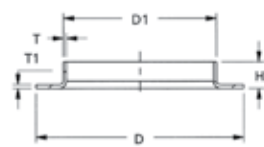

Pressed collars

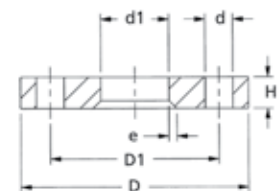

Flanges



# Stainless Steel

## Seamless Tube

Seamless Stainless Steel Tube ASTM A269/A213  
Grade 316



Size	KG/Metre
1/8" OD X 0.022" (24swg)	0.04
1/8" OD X 0.028" (22swg)	0.04
1/8" OD X 0.036" (20swg)	0.05
3/16" OD X 0.022" (24swg)	0.06
3/16" OD X 0.028" (22swg)	0.07
3/16" OD X 0.036" (20swg)	0.09
3/16" OD X 0.048" (18swg)	0.11
1/4" OD X 0.028" (22swg)	0.10
1/4" OD X 0.036" (20swg)	0.12
1/4" OD X 0.048" (18swg)	0.16
1/4" OD X 0.064" (16swg)	0.19
5/16" OD X 0.028" (22swg)	0.13
5/16" OD X 0.036" (20swg)	0.16
5/16" OD X 0.064" (16swg)	0.26
3/8" OD X 0.028" (22swg)	0.16
3/8" OD X 0.036" (20swg)	0.20
3/8" OD X 0.048" (18swg)	0.25
3/8" OD X 0.064" (16swg)	0.32
3/8" OD X 0.080" (14swg)	0.38
1/2" OD X 0.028" (22swg)	0.21
1/2" OD X 0.036" (20swg)	0.26
1/2" OD X 0.048" (18swg)	0.35
1/2" OD X 0.064" (16swg)	0.45
1/2" OD X 0.080" (14swg)	0.54
1/2" OD X 0.125"	0.76
3/4" OD X 0.036" (20swg)	0.34

continued...

Size	KG/Metre
5/8" OD X 0.048" (18swg)	0.45
5/8" OD X 0.064" (16swg)	0.58
5/8" OD X 0.080" (14swg)	0.70
5/8" OD X 0.125"	1.01
3/4" OD X 0.036" (20swg)	0.41
3/4" OD X 0.048" (18swg)	0.54
3/4" OD X 0.064" (16swg)	0.71
3/4" OD X 0.080" (14swg)	0.86
3/4" OD X 0.104" (12swg)	1.08
3/4" OD X 0.128" (10swg)	1.26
7/8" OD X 0.064" (16swg)	0.84
1" OD X 0.036" (20swg)	0.56
1" OD X 0.048" (18swg)	0.74
1" OD X 0.064" (16swg)	0.97
1" OD X 0.080" (14swg)	1.19
1" OD X 0.104" (12swg)	1.50
1" OD X 0.128" (10swg)	1.77
1 1/4" OD X 0.064" (16swg)	1.20
1 1/4" OD X 0.080" (14swg)	1.50
1 1/4" OD X 0.125"	2.30
1 1/2" OD X 0.064" (16swg)	1.50
1 1/2" OD X 0.125"	2.80
2" OD X 0.125"	3.79
2" OD X 0.250"	7.06
2 1/2" OD X 0.25"	9.10
3" OD X 0.064" (16swg)	3.00

continued...

Size	KG/Metre
3" OD X 0.128" (10swg)	5.90
3" OD X 0.250"	11.09

# Stainless Steel

## Seamless Tube

Seamless Stainless Steel Tube ASTM A269/A213  
Grade 316

Size	KG/Metre
6.0mm OD X 0.50mm	0.07
6.0mm OD X 1.0mm	0.13
6.0mm OD X 1.5mm	0.17
8.0mm OD X 1.0mm	0.18
8.0mm OD X 1.5mm	0.24
10.0mm OD X 1.0mm	0.23
10.0mm OD X 1.5mm	0.32
10.0mm OD X 2.0mm	0.40
12.0mm OD X 1.0mm	0.30
12.0mm OD X 1.5mm	0.39
12.0mm OD X 2.0mm	0.50
15.0mm OD X 1.5mm	0.50
16.0mm OD X 1.5mm	0.54
16.0mm OD X 2.0mm	0.70
18.0mm OD X 1.5mm	0.61
20.0mm OD X 1.5mm	0.69
20.0mm OD X 2.0mm	0.90
22.0mm OD X 1.5mm	0.77
25.0mm OD X 1.5mm	0.90
25.0mm OD X 2.0mm	1.20
25.0mm OD X 2.5mm	1.40
25.0mm OD X 3.0mm	1.70

Seamless Stainless Steel Tube ASTM A269/A213  
Grade 304

Size	KG/Metre
6.0mm OD X 1.0mm	0.12
10.0mm OD X 1.0mm	0.22
12.0mm OD X 1.0mm	0.30
15.0mm OD X 1.5mm	0.50

Seamless Stainless Steel Tube ASTM A269/A213  
Grade 304

Size	KG/Metre
¼" OD X 0.036" (20swg)	0.12
⅝" OD X 0.036" (20swg)	0.34
½" OD X 0.048" (18swg)	0.35
¾" OD X 0.036" (20swg)	0.41
⅝" OD X 0.048" (18swg)	0.44
⅝" OD X 0.064" (16swg)	0.58
¾" OD X 0.064" (16swg)	0.70
1" OD X 0.048" (18swg)	0.73



# Stainless Steel

## BSP Fittings

Sizes: 1/8", 1/4", 3/8", 1/2", 3/4", 1", 1 1/2", 2", 3"



90° Elbow

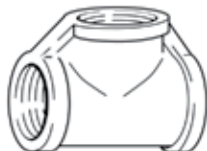

Equal Tee

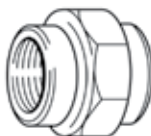

Union



45° Elbow



Half Socket

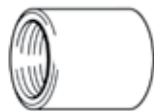

Socket



Round Nut



Reducing Socket

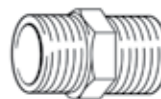

Hexagon Nipple

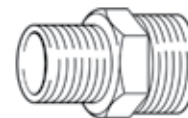

Reducing Nipple



Equal Nipple



Cap



Barrel Nipple



Welding Nipple



Square Head Plug



Hexagon Head Plug



Hose Connector

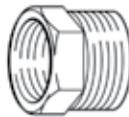

Reducing Bush



Hexagon Nut

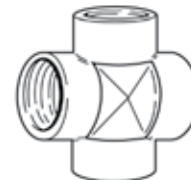

Cross

# Stainless Steel

## Hygienic Tube and Fittings

Stainless Steel Hygienic Tube to ASTM A270 Grades 304L & 316L. Available in Bright Annealed or with Satin Polished O/D

Size	KG/Metre
¾" O/D X 16SWG	0.72
1" O/D X 16SWG	0.97
1½" O/D X 16SWG	1.45
2" O/D X 16SWG	1.99
2½" O/D X 16SWG	2.51
3" O/D X 16SWG	3.02
4" O/D X 16SWG	4.04
4" O/D X 14SWG	5.02

Stainless Steel Hygienic Tube to DIN 11850 - UN-ANNEALED - Grade 316L. Available Descaled or with Satin Polished O/D

Size	KG/Metre
1" OD X 1.5mm	0.9
1½"OD X 1.5mm	1.37
2" OD X 1.5mm	1.85
2½"OD X 1.5mm	2.33
3" OD X 1.5mm	2.8
4" OD X 1.5mm	3.75
4" OD X 2.0mm	4.98
4" O/D X 14SWG	5.02

Stainless Steel Hygienic Tube to DIN 11850 - UN-ANNEALED - Grade 304. Available Descaled or with Satin Polished O/D

Size	KG/Metre
1" OD X 1.5mm	0.9
1½" OD x 1.5mm	1.37
2" OD X 1.5mm	1.85



Clamp Fittings



RJT Unions



IDF Unions



Hinged Pipe Clip



Hygienic Bends



Pulled Tees



Full Tees



Reducing Tees



Concentric and Eccentric Reducers

# Stainless Steel

## Handrail Tube and Fittings

Stainless Steel Handrail Tube Grade 304 & 316 - Satin Polish O/D

Size	KG/Metre
1" OD X 3.0mm	1.68
2" OD X 3.0mm	3.57
3" OD X 3.0mm	5.46
4" OD X 3.0mm	7.40
42.4mm OD X 2.0mm	2.01
48.3mm OD x 2.0mm	2.32
60.3mm OD X 2.0mm	2.92
42.4mm OD X 2.5mm	2.49
48.3mm OD X 2.5mm	2.86
60.3mm OD X 2.5mm	3.61

Stainless Steel UN-ANNEALED Handrail Tube Grade 304 - Descaled Finish

Size	KG/Metre
42.2mm OD X 1.6mm 304	1.62
60.3mm OD X 1.6mm 304	2.33
76.1mm OD X 1.6mm 304	2.96
101.6mm OD X 2.0mm 304	4.94



Glass Clamps



Glass Clamp



Glass Clamp



Glass Clamp



Glass Clamp

Fittings



Adjustable Elbow



90 Degree Elbow



45 Degree Elbow



90 Degree Curved Elbow

Fittings



Flexible Elbow



Internal Connector



Crossbar Holder Intermediate



Flush Tee Connector

Fittings



4-way Corner Connector



Cross Connector



3-way Corner Connector



Adaptor

## Stainless Steel

## Handrail Tube and fittings



Mountings



Floor Base (indoor use)

Mountings



Floor Base (outdoor use)

Mountings



Elbow with Flange

End Caps



Flat Cap

Handrail Brackets



Straight Saddle

Handrail Brackets



Handrail Holder



Disc



Cover Plate



Elbow with Flange



End Caps



Adjustable Saddle



Handrail Holder



Wall Flange



Disc

End Caps



End Caps

End Caps with M8



End Caps



Wall Support



Handrail Holder



Side Mounted Base



Side Mounted Base



Wall Support

# Stainless Steel

## Slotted Tube system and fittings

Stainless Steel Slotted Handrail Tube  
Grades 304 & 316

Size	KG/Metre
42.2MM X 1.5MM	1.83
48.3MM X 1.5MM	2.17



Slotted tube



End caps



90 degree angle - vertical



90 degree angle - horizontal



Connector



Rubber inserts

# Stainless Steel

## Accessories - Adhesive & Cleaners



Degreasing Spray



Protection Spray



Stainless Steel Cleaning & Passivation Kit



Stainless Steel Glue

The kit comprises a viscous deep cleaner that removes contamination such as oxides/rust/tea-stains plus a passivating agent that will also remove contamination loosened by the deep cleaner. An application sponge is also included.



# Aalco Copper, Brass & Bronze

Copper	
Sheet.....	58
Rod .....	58
Flat Bar.....	59
Round Tube .....	60
Brass	
Sheet.....	61
Rod .....	62
Hexagon Bar.....	64
Flat Bar.....	65
Plate.....	66
Tube .....	66
Square Bar.....	66
Equal Angle.....	66
Bronze	
Rod .....	67



# Copper Sheet



Copper Sheet Alloy CW024A/C106 Half Hard

Size	KG/Sheet
4' X 2' X 24SWG	3.70
4' X 2' X 22SWG	4.70
4' X 2' X 20SWG	6.02
4' X 2' X 18SWG	8.07
4' X 2' X 16SWG	10.8
4' X 2' X 14SWG	13.4
4' X 2' X 10SWG	21.5
8' X 4' X 18SWG	32.3
8' X 4' X 1.6mm	42.3
8' X 4' X 2.0mm	52.9
8' X 4' X 3.0mm	79.4
8' X 4' X 4.0mm	105.8
2000mm X 1000mm X 0.55mm	9.8
2000mm X 1000mm X 0.7mm	12.5
2000mm X 1000mm X 0.9mm	16.0
2000mm X 1000mm X 1.2mm	21.4
2000mm X 1000mm X 1.5mm	26.7
2000mm X 1000mm X 2.0mm	35.6
2000mm X 1000mm X 2.5mm	44.5
2000mm X 1000mm X 3.0mm	53.4
2000mm X 1000mm X 4.0mm	74.0
2000mm X 1000mm X 5.0mm	92.6
2000mm X 1000mm X 6.0mm	111



Copper Sheet Alloy CW004A/C101 Half Hard

Size	KG/Sheet
4' X 2' X 20SWG	6.02
4' X 2' X 10SWG	21.5
1200mm X 600mm X 1.6mm	10.3
1200mm X 600mm X 2.0mm	12.8
2000mm X 1000mm X 0.9mm	16.0
2000mm X 1000mm X 1.2mm	21.4
2000mm X 1000mm X 1.5mm	26.7
2000mm X 1000mm X 2.0mm	35.6
2000mm X 1000mm X 3.0mm	53.4
2000mm X 1000mm X 4.0mm	74.0
2000mm X 1000mm X 5.0mm	92.6
2000mm X 1000mm X 6.0mm	111

Copper Sheet Alloy CW024A/C106 - Soft - Spinning Quality

Size	KG/Sheet
4' X 2' X 24SWG	3.70
4' X 2' X 20SWG	6.02
4' X 2' X 18SWG	8.07
2000mm X 1000mm X 0.55mm	9.8
2000mm X 1000mm X 0.7mm	12.5
2000mm X 1000mm X 0.9mm	16.0
2000mm X 1000mm X 1.2mm	21.4
2000mm X 1000mm X 1.5mm	26.7

# Rod



Copper Rod CW004A/C101 - Hard Drawn High Conductivity

Size	KG/Metre
¼" DIA	0.28
⅝" DIA	0.44
⅜" DIA	0.63
½" DIA	1.13
⅝" DIA	1.76
¾" DIA	2.54
7⁄8" DIA	3.45
1" DIA	4.51
1⅛" DIA	5.71
1¼" DIA	7.05
1⅜" DIA	8.53
1½" DIA	10.1
1⅝" DIA	11.9
2" DIA	18.0
2¼" DIA	22.8
2½" DIA	28.2
4" DIA	72.2
10.0mm DIA	0.70
12.0mm DIA	1.01
16.0mm DIA	1.79
20.0mm DIA	2.80
25.0mm DIA	4.37
30.0mm DIA	6.29
40.0mm DIA	11.2
50.0mm DIA	17.5

# Copper

## Flat Bar



Copper Flat Bar - Radius Edge - Alloy CW004A/C101

Size	KG/Metre
½" X ⅛" Rad Edge	0.36
½" X ⅜" Rad Edge	0.54
⅝" X ⅛" Rad Edge	0.45
½" X ¼" Rad Edge	0.72
¾" X ⅛" Rad Edge	0.54
¾" X ⅜" Rad Edge	0.81
¾" X ¼" Rad Edge	1.08
1" X ⅛" Rad Edge	0.72
1" X ⅜" Rad Edge	1.07
1" X ¼" Rad Edge	1.44
1" X ½" Rad Edge	2.87
1¼" X ⅛" Rad Edge	0.90
1¼" X ¼" Rad Edge	1.79
1½" X ⅛" Rad Edge	1.08
1½" X ⅜" Rad Edge	1.61
1½" X ¼" Rad Edge	2.15
1½" X ⅝" Rad Edge	3.23
2" X ⅛" Rad Edge	1.44
2" X ⅜" Rad Edge	2.15
2" X ¼" Rad Edge	2.87
2" X ⅝" Rad Edge	4.31
2" X ½" Rad Edge	5.74
2" X ¾" Rad Edge	8.61
2½" X ¼" Rad Edge	3.59
2½" X ⅝" Rad Edge	5.39
2½" X ½" Rad Edge	7.18

continued...

Size	KG/Metre
3" X ¼" Rad Edge	4.31
3" X ⅜" Rad Edge	6.46
3" X ½" Rad Edge	8.61
4" X ¼" Rad Edge	5.74
4" X ⅜" Rad Edge	8.62
4" X ½" Rad Edge	11.48
5" X ¼" Rad Edge	7.18
5" X ½" Rad Edge	14.35
6" X ¼" Rad Edge	8.61
20mm X 5mm Rad Edge	0.89
20mm X 6mm Rad Edge	1.07
20mm X 10mm Rad Edge	1.78
25mm X 3mm Rad Edge	0.67
25mm X 5mm Rad Edge	1.11
25mm X 6mm Rad Edge	1.34
25mm X 10mm Rad Edge	2.23
30mm X 3mm Rad Edge	0.80
30mm X 5mm Rad Edge	1.34
30mm X 6mm Rad Edge	1.60
30mm X 10mm Rad Edge	2.67
40mm X 5mm Rad Edge	1.78
40mm X 6mm Rad Edge	2.14
40mm X 8mm Rad Edge	2.85
40mm X 10mm Rad Edge	3.56
50mm X 5mm Rad Edge	2.23

continued...

Size	KG/Metre
50mm X 6mm Rad Edge	2.67
50mm X 8mm Rad Edge	3.56
50mm X 10mm Rad Edge	4.45
50mm X 12mm Rad Edge	5.34
60mm X 6mm Rad Edge	3.20
60mm X 10mm Rad Edge	5.34
80mm X 10mm Rad Edge	7.12
100mm X 6mm Rad Edge	5.34
100mm X 10mm Rad Edge	8.90
120mm X 10mm Rad Edge	10.68
150mm X 6mm Rad Edge	8.01
150mm X 10mm Rad Edge	13.35
200mm X 10mm Rad Edge	17.80

# Copper

## Round Tube

Copper Tube Alloy CW024A/C106



Size	KG/Metre
¼ o/d X 20 swg	0.14
¼ o/d X 18 swg	0.17
⅜ o/d X 20 swg	0.22
⅜ o/d X 18 swg	0.29
½ o/d X 20 swg	0.30
½ o/d X 18 swg	0.39
½ o/d X 16 swg	0.50
⅝ o/d X 20 swg	0.38
¾ o/d X 20 swg	0.46
¾ o/d X 18 swg	0.61
¾ o/d X 16 swg	0.79
7/8 o/d X 20 swg	0.54
7/8 o/d X 18 swg	0.72
7/8 o/d X 16 swg	0.94
1 o/d X 20 swg	0.63
1 o/d X 18 swg	0.83
1 o/d X 16 swg	1.08
1¼ o/d X 16 swg	1.37
1½ o/d X 16 swg	1.66
2 o/d X 16 swg	2.24
2½ o/d X 16 swg	2.81

# Brass

## Sheet

**Brass Sheet Alloy CW508L/CZ108 - In Half Hard Condition**

Size	KG/Sheet
4' X 2' X 0.55mm	3.45
4' X 2' X 0.90mm	5.65
4' X 2' X 18SWG	7.66
4' X 2' X 16SWG	10.24
4' X 2' X 2.0mm	12.6
4' X 2' X 12SWG	16.7
4' X 2' X 10SWG	20.4
8' X 1000mm X 0.9mm	18.5
8' X 1000mm X 1.2mm	24.7
8' X 1000mm X 1.5mm	30.9
8' X 4' X 18SWG	30.6
8' X 4' X 1.6mm	40.2
8' X 4' X 14SWG	51.0
8' X 4' X 10SWG	81.6
2000mm X 1000mm X 0.45mm	7.61
2000mm X 1000mm X 0.55mm	9.30
2000mm X 1000mm X 0.7mm	11.83
2000mm X 1000mm X 0.9mm	15.21
2000mm X 1000mm X 1.2mm	20.28
2000mm X 1000mm X 1.5mm	25.35
2000mm X 1000mm X 2.0mm	33.80
2000mm X 1000mm X 2.5mm	42.25
2000mm X 1000mm X 3.0mm	50.70

**Brass Sheet Alloy CW505L/CZ106 - In Soft (O) Condition**

Size	KG/Sheet
4' X 2' X 24SWG	3.51
4' X 2' X 20SWG	5.70
4' X 2' X 18SWG	7.64
2000mm X 1000mm X 0.55mm	9.27
2000mm X 1000mm X 0.7mm	11.80
2000mm X 1000mm X 0.9mm	15.17
2000mm X 1000mm X 1.2mm	20.23
2000mm X 1000mm X 1.6mm	26.98
2000mm X 1000mm X 2.0mm	33.72

**Polished Brass Sheet Alloy CW508L/CZ108 - In Half Hard Condition**

Size	KG/Sheet
2000mm X 1000mm X 0.55mm	9.43
2000mm X 1000mm X 0.7mm	12.0
2000mm X 1000mm X 0.9mm	15.4
2000mm X 1000mm X 1.2mm	20.6
2000mm X 1000mm X 1.5mm	25.7
2000mm X 1000mm X 2.0mm	34.3
2000mm X 1000mm X 2.5mm	42.9
2000mm X 1000mm X 3.0mm	51.5
8' X 1000mm X 1.2mm	25.1
8' X 1000mm X 1.5mm	31.4



# Brass

## Rod



Brass Rod Alloy CW614N/CZ121 - Free Machining Brass

Size	KG/Metre
1/8" DIA	0.07
5/32" DIA	0.11
4.0mm DIA	0.11
3/16" DIA	0.15
5.0mm DIA	0.17
7/32" DIA	0.21
6.0mm DIA	0.24
1/4" DIA	0.27
7.0mm DIA	0.33
9/32" DIA	0.34
5/16" DIA	0.42
8.0mm DIA	0.43
11/32" DIA	0.51
9.0mm DIA	0.54
3/8" DIA	0.61
10.0mm DIA	0.67
7/16" DIA	0.82
12.0mm DIA	0.96
1/2" DIA	1.08
13.0mm DIA	1.13
17/32" DIA	1.21
14.0mm DIA	1.31
9/16" DIA	1.36
15.0mm DIA	1.50
5/8" DIA	1.68
16.0mm DIA	1.71

continued...

Size	KG/Metre
17.0mm DIA	1.93
11/16" DIA	2.04
18.0mm DIA	2.16
3/4" DIA	2.42
20.0mm DIA	2.67
13/16" DIA	2.84
22.0mm DIA	3.23
7/8" DIA	3.30
15/16" DIA	3.78
24.0mm DIA	3.85
25.0mm DIA	4.17
1" DIA	4.31
26.0mm DIA	4.51
1 1/16" DIA	4.86
28.0mm DIA	5.23
1 1/8" DIA	5.45
30.0mm DIA	6.01
1 3/16" DIA	6.07
1 1/4" DIA	6.73
1 5/16" DIA	7.42
1 3/8" DIA	8.15
35.0mm DIA	8.18
1 1/2" DIA	9.69
40.0mm DIA	10.7
1 5/8" DIA	11.4
1 3/4" DIA	13.2

continued...

Size	KG/Metre
1 7/8" DIA	15.1
50.0mm DIA	16.7
2" DIA	17.2
2 1/8" DIA	19.4
2 1/4" DIA	21.8
60.0mm DIA	24.0
2 3/8" DIA	24.3
2 1/2" DIA	26.9
65.0mm DIA	28.2
2 5/8" DIA	29.7
2 3/4" DIA	32.6
3" DIA	38.8
3 1/4" DIA	45.5
3 1/2" DIA	52.8
3 3/4" DIA	60.6
4" DIA	68.9
4 1/4" DIA	77.8
4 1/2" DIA	87.2
130mm DIA	113
155mm DIA	160
180mm DIA	216
205mm DIA	281

# Brass

## Rod

Brass Rod Alloy CW721R / CZ114 - High Tensile Brass / Manganese Bronze

Size	KG/Metre
3/8" DIA	0.59
1/2" DIA	1.04
5/8" DIA	1.63
3/4" DIA	2.34
13/16" DIA	2.75
7/8" DIA	3.19
1" DIA	4.16
1 1/4" DIA	6.51
1 3/8" DIA	7.87
1 1/2" DIA	9.37
1 3/4" DIA	12.8
2" DIA	16.7
2 1/4" DIA	21.1
2 1/2" DIA	26.0
2 3/4" DIA	31.5
3" DIA	37.5
4" DIA	66.6

Brass Rod Alloy CW606N/CZ131 - Riveting Quality Brass

Size	KG/Metre
1/4" DIA	0.27
5/16" DIA	0.42
3/8" DIA	0.61
7/16" DIA	0.82
1/2" DIA	1.08
5/8" DIA	1.68
3/4" DIA	2.42

Brass Rod Alloy CW712R/CZ112 - Naval Brass

Size	KG/Metre
3/4" DIA	2.41
1" DIA	4.28
1 1/4" DIA	6.69
1 1/2" DIA	9.63
1 3/4" DIA	13.1
2" DIA	17.1
2 1/2" DIA	26.8
3" DIA	38.5



# Brass

## Hexagon Bar



Brass Hexagon Bar Alloy CW614N/CZ121

Size	KG/Metre
5.0mm A/F	0.18
6.0mm A/F	0.27
0.248" A/F	0.29
¼" A/F	0.30
⅜" A/F	0.46
8.0mm A/F	0.47
0.324" A/F	0.50
⅝" A/F	0.67
10.0mm A/F	0.74
11.0mm A/F	0.89
⅞" A/F	0.91
0.445" A/F	0.94
12.0mm A/F	1.06
½" A/F	1.19
13.0mm A/F	1.24
0.525" A/F	1.31
14.0mm A/F	1.44
⅞" A/F	1.50
15.0mm A/F	1.66
.600" A/F	1.71
⅞" A/F	1.71
16.0mm A/F	1.88
17.0mm A/F	2.13
1⅜" A/F	2.24
18.0mm A/F	2.39
0.710" A/F	2.39

continued...

Size	KG/Metre
19.0mm A/F	2.66
¾" A/F	2.67
20.0mm A/F	2.94
1⅜" A/F	3.14
0.820" A/F	3.19
22.0mm A/F	3.56
⅞" A/F	3.64
0.920" A/F	4.02
1⅝" A/F	4.17
24.0mm A/F	4.24
1" A/F	4.75
1.010" A/F	4.84
1⅞" A/F	5.36
1.100" A/F	5.75
1⅞" A/F	6.01
30.0mm A/F	6.63
1.200" A/F	6.84
1¼" A/F	7.42
32.0mm A/F	7.54
1.300" A/F	8.03
1⅝" A/F	8.18
1⅞" A/F	8.98
36.0mm A/F	9.54
1.480" A/F	10.40
1½" A/F	10.69
41.0mm A/F	12.37

continued...

Size	KG/Metre
1.625" A/F	12.54
1.670" A/F	13.25
46.0mm A/F	15.58
1.860" A/F	16.43
50.0mm A/F	18.40
2.050" A/F	19.96
2.200" A/F	22.99
60.0mm A/F	26.50
2½" A/F	29.68
65.0mm A/F	31.10
2¾" A/F	35.92
3" A/F	42.74



# Brass

## Flat Bar



Brass Flat Bar CW614N/CZ121

Size	KG/Metre
3/8" X 1/8"	0.26
3/8" X 1/4"	0.51
1/2" X 1/8"	0.34
5/8" X 1/8"	0.43
5/8" X 1/4"	0.86
5/8" X 3/8"	1.29
1/2" X 1/4"	0.69
3/4" X 1/8"	0.51
3/4" X 3/16"	0.77
3/4" X 1/4"	1.03
3/4" X 3/8"	1.54
3/4" X 1/2"	2.06
1" X 1/8"	0.69
1" X 3/16"	1.03
1" X 1/4"	1.37
1" X 5/16"	1.71
1" X 3/8"	2.06
1" X 1/2"	2.74
1" X 5/8"	3.43
1" X 3/4"	4.11
1 1/4" X 1/8"	0.86
1 1/4" X 1/4"	1.71
1 1/4" X 3/8"	2.57
1 1/4" X 1/2"	3.43
1 1/4" X 3/4"	5.14
1 1/4" X 1"	6.85

continued...

Size	KG/Metre
1 1/2" X 1/8"	1.03
1 1/2" X 3/16"	1.54
1 1/2" X 1/4"	2.06
1 1/2" X 3/8"	3.09
1 1/2" X 1/2"	4.11
1 1/2" X 3/4"	5.14
1 1/2" X 1"	6.17
1 1/2" X 1 1/4"	8.23
1 3/4" X 1/2"	4.80
2" X 1/8"	1.37
2" X 3/16"	2.05
2" X 1/4"	2.74
2" X 3/8"	4.12
2" X 1/2"	5.48
2" X 5/8"	6.86
2" X 3/4"	8.23
2" X 1"	10.97
2" X 1 1/4"	13.71
2" X 1 1/2"	16.45
2 1/2" X 1/4"	3.43
2 1/2" X 3/8"	5.14
2 1/2" X 1/2"	6.85
2 1/2" X 3/4"	10.28
2 1/2" X 1"	13.71
2 1/2" X 1 1/4"	17.14
2 1/2" X 1 1/2"	20.56

continued...

Size	KG/Metre
3" X 1/8"	2.06
3" X 1/4"	4.11
3" X 3/8"	6.17
3" X 1/2"	8.23
3" X 1"	16.45
3" X 1 1/2"	24.68
3" X 2"	32.90
4" X 1/8"	2.75
4" X 1/4"	5.48
4" X 1/2"	10.97
4" X 3/4"	16.45
4" X 1 1/2"	32.90

## Brass Plate



Brass Plate Alloy CW508L/CZ108 Half Hard

Size	KG/Plate
2000mm X 1000mm X 4.0mm	69
2000mm X 1000mm X 4.76mm	82
2000mm X 1000mm X 5.0mm	86
2000mm X 1000mm X 6.35mm	109



## Tube

Brass Tube for Handrail/Bar-rail Alloy CW508L/CZ108

Size	KG/Metre
2" O/D X 16SWG	2.13

## Square Bar



Brass Square Bar Alloy CW614N/CZ121

Size	KG/Metre
¼" SQ	0.34
⅝" SQ	0.54
⅜" SQ	0.77
⅞" SQ	1.05
½" SQ	1.37
⅝" SQ	2.14
¾" SQ	3.08
⅞" SQ	4.20
1" SQ	5.48
1¼" SQ	8.57
1½" SQ	12.3
1¾" SQ	16.8
2" SQ	21.9
2¼" SQ	27.8
2½" SQ	34.3
3" SQ	49.4

## Equal Angle



Brass Angle Alloy CW624N/CZ130

Size	KG/Metre
½" X ½" X ½"	0.62
¾" X ¾" X ½"	0.97
1" X 1" X ½"	1.33
1¼" X 1¼" X ½"	1.68
1½" X 1½" X ½"	2.03
1½" X 1½" X ⅜"	2.98
2" X 2" X ½"	2.74
2" X 2" X ¼"	5.30
3" X 3" X ¼"	8.12

# Bronze Rod

Aluminium Bronze Rod CW307G/CA104

Size	KG/Metre
½"	0.96
⅝"	1.50
¾"	2.35
1"	3.85
1¼"	6.10
1½"	8.66
1¾"	12.00
2"	15.40
2¼"	21.00
2½"	24.90
2¾"	29.60
3"	34.70
3½"	47.20
4"	61.60
4½"	78.0
5"	96.3
5½"	116
6"	139
6½"	165
7"	189
7½"	249
8"	276
9"	312
10"	385
12"	556

Aluminium Bronze Rod DEF-STAN 833 (NES 833)  
Grade 1

Size	KG/Metre
⅜"	0.54
½"	0.96
⅝"	1.50
¾"	2.17
⅞"	2.96
1"	3.85
1¼"	6.02
1½"	8.66
1¾"	11.8
2"	15.4
2½"	24.1
3"	34.7
3½"	47.2
4"	61.6
4½"	78.0
5"	96.3
5½"	116
6"	139
6½"	165
7"	189
8"	249

Phosphor Bronze Rod CW451K/PB102

Size	KG/Metre
½"	1.12
⅝"	1.75
¾"	2.52
⅞"	3.43
1"	4.48
1⅛"	5.68
1¼"	7.01
1⅜"	8.48
1½"	10.0
1¾"	13.7
2"	17.9
2¼"	22.7
2½"	28.0
2¾"	33.9
3"	40.4
3¼"	47.6
3½"	54.9
4"	71.7



**ABERDEEN**

Unit 9B, Peterseat Drive  
Peterseat Park  
Altens Industrial Estate  
Aberdeen  
AB12 3HT  
Tel: 01224 854810  
Fax: 01224 871982  
Email: aberdeen@aalco.co.uk

**DYFED**

Units 3-4  
Capel Hendre Industrial Estate  
Ammanford  
Carmarthenshire  
SA18 3SJ  
Tel: 01269 842044  
Fax: 01269 845276  
Email: dyfed@aalco.co.uk

**LIVERPOOL**

207 Great Howard Street  
Liverpool  
L5 9ZH  
Tel: 0151 207 3551  
Fax: 0151 207 2657  
Email: liverpool@aalco.co.uk

**AYLESBURY**

Unit 1, Premus  
Coldharbour Way  
Aylesbury  
Buckinghamshire  
HP19 8AP  
Tel: 01296 461700  
Fax: 01296 339923  
Email: aylesbury@aalco.co.uk

**ESSEX**

Unit 2, Carnival Park  
Festival Way  
Basildon  
Essex  
SS14 3WN  
Tel: 01268 884200  
Fax: 01268 884220  
Email: essex@aalco.co.uk

**MANCHESTER**

Express Trading Estate  
Stone Hill Road  
Farnworth  
Bolton  
BL4 9NN  
Tel: 01204 863456  
Fax: 01204 863430  
Email: manchester@aalco.co.uk

**SOUTHAMPTON**

Test Lane  
Nursling  
Southampton  
SO16 9TA  
Tel: 023 8087 5200  
Fax: 023 8087 5275  
Email: southampton@aalco.co.uk

**BELFAST**

The Belfast Metal Centre  
20 McKinney Road  
Newtownabbey  
BT36 4PE  
Tel: 02890 838 838  
Fax: 02890 837 837  
Email: belfast@aalco.co.uk

**GLASGOW**

117 Clydesmill Place  
Cambuslang Investment Park  
Glasgow  
G32 8RF  
Tel: 0141 646 3200  
Fax: 0141 646 3260  
Email: glasgow@aalco.co.uk

**NEWCASTLE**

First Avenue  
Team Valley Trading Estate  
Gateshead  
Tyne & Wear  
NE11 0NU  
Tel: 0191 491 1133  
Fax: 0191 491 1177  
Email: newcastle@aalco.co.uk

**STOKE**

Unit F, Forge Way  
Brown Lees Industrial Estate  
Biddulph  
Stoke-on-Trent  
ST8 7DN  
Tel: 01782 375700  
Fax: 01782 375701  
Email: stoke@aalco.co.uk

**BIRMINGHAM**

Shelah Road  
Halesowen  
West Midlands  
B63 3PH  
Tel: 0121 585 3600  
Fax: 0121 585 6864  
Email: birmingham@aalco.co.uk

**HULL**

Saxon Way  
Priory Park West  
Hessle  
Hull  
HU13 9PB  
Tel: 01482 626262  
Fax: 01482 626263  
Email: hull@aalco.co.uk

**NORWICH**

Roundtree Way  
Mousehold Lane  
Norwich  
NR7 8SR  
Tel: 01603 787878  
Fax: 01603 789999  
Email: norwich@aalco.co.uk

**SWANLEY**

Unit 7  
The Interchange  
Wested Lane  
Swanley, Kent  
BR8 8TE  
Tel: 01322 610900  
Fax: 01322 610910  
Email: swanley@aalco.co.uk

**CHEPSTOW**

Avenue West  
Newhouse Park Estate  
Chepstow  
Monmouthshire  
NP16 6UD  
Tel: 01291 638 638  
Fax: 01291 638 600  
Email: chepstow@aalco.co.uk

**LEEDS**

Unit 1  
Revie Road off Elland Road  
Leeds  
LS11 8JG  
Tel: 0113 276 3300  
Fax: 0113 276 0382  
Email: leeds@aalco.co.uk

**NOTTINGHAM**

Harrimans Lane  
Dunkirk  
Nottingham  
NG7 2SD  
Tel: 0115 988 2600  
Fax: 0115 988 2636  
Email: nottingham@aalco.co.uk

AMARI also available in Ireland



**DUBLIN**

Tel: +353 (0) 1 629 8600  
Fax: +353 (0) 1 629 9200  
Email: dublin@amari-dublin.com

**CORK**

Tel: +353 (0) 21 4310 520  
Fax: +353 (0) 21 4310 519  
Email: cork@amari-cork.com